

# Vodafone 360 Samsung H1 user manual



# using this manual

## **Read me first!**

---

When you need information, instructions, and tips to learn more about your device, you can use the online user manual.

This user manual has been specially designed to guide you through the functions and features of your device. It contains extensive information about Samsung software and features and tips for using and maintaining the device.

On the Samsung website, you will find the user manual in Adobe Acrobat (.pdf) format. You can either view the guide online or download and print the file for your convenience. To view the file, you must have Adobe Reader or Adobe Acrobat installed-you can download Adobe Reader free from Adobe's website ([www.adobe.com](http://www.adobe.com)).

## Instructional icons

---

Before you start, familiarise yourself with the icons you will see in this manual:



**Warning**—situations that could cause injury to yourself or others



**Caution**—situations that could cause damage to your device or other equipment



**Note**—notes, usage tips, or additional information



**Refer to**—pages with related information; for example: ► p. 12 (represents "see page 12")



**Followed by**—the order of options or menus you must select to perform a step; for example: In Apps view, select **Settings** → **Phone profile** (represents **Settings**, followed by **Phone profile**)



**Square brackets**—device keys; for example: [⏻] (represents the Power key).

## Copyrights and trademarks

Rights to all technologies and products that comprise this device are the property of their respective owners:

- Bluetooth® is a registered trademark of the Bluetooth SIG, Inc. worldwide.  
Bluetooth QD ID: B015544
- Java™ is a trademark of Sun Microsystems, Inc.
- Wi-Fi®, the Wi-Fi CERTIFIED logo, and the Wi-Fi logo are registered trademarks of the Wi-Fi Alliance.
- DivX® is a registered trademark of DivX, Inc., and is used under licence.  
Pat. 7,295,673



CE 0168

**ABOUT DIVX VIDEO:** DivX® is a digital video format created by DivX, Inc. This is an official DivX Certified device that plays DivX video. Visit [www.divx.com](http://www.divx.com) for more information and software tools to convert your files into DivX video.

**ABOUT DIVX VIDEO-ON-DEMAND:** This DivX Certified® device must be registered in order to play DivX Video-on-Demand (VOD) content. To generate the registration code, locate the DivX VOD section in the device setup menu. Go to [vod.divx.com](http://vod.divx.com) with this code to complete the registration process and learn more about DivX VOD.

DivX Certified to play DivX® video up to 640x480, including premium content



LiMo Foundation™ R2 Device

LiMo and the star design are trademarks of Limo Foundation Inc. and are used with permission.

# contents

<b>introducing your device .....</b>	<b>1</b>
Unpack .....	1
Device layout .....	2
Keys .....	3
Icons .....	3
<b>getting started with your device .....</b>	<b>5</b>
Assemble and prepare your device .....	5
Turn your device on and off .....	9
Use the touch screen .....	10
Switch your device's modes .....	12
Access applications .....	13
Open the status bar .....	14
Download applications from Shop .....	14
Enter text .....	14
Customise your device .....	16
Search for data .....	17
<b>communication .....</b>	<b>18</b>
Calling .....	18
Text and multimedia messages .....	21
Voicemails .....	22
Email messages .....	23
Chat .....	23

<b>media</b> .....	<b>24</b>	<b>additional programs</b> .....	<b>52</b>
Music .....	24	Alarm .....	52
Camera .....	26	World Clock .....	53
Gallery .....	30	Calculator .....	53
My Files .....	32	Units .....	54
Radio .....	33	Stopwatch .....	54
Voice Recorder .....	34	Card Scanner .....	54
PC Studio .....	35	Maps .....	55
<b>personal productivity</b> .....	<b>36</b>	<b>settings</b> .....	<b>57</b>
Contacts .....	36	<b>Vodafone 360</b> .....	<b>57</b>
Calendar .....	38	Phone profile .....	57
File Viewer .....	39	Display and light .....	57
Notes .....	40	Time and date .....	58
<b>web applications</b> .....	<b>41</b>	Phone settings .....	58
Internet .....	41	Application settings .....	58
Web Player .....	42	Network settings .....	59
RSS .....	43	Security .....	59
<b>connectivity</b> .....	<b>45</b>	Memory settings .....	60
Wi-Fi .....	45	Reset settings .....	60
Bluetooth .....	46	Open source licence .....	60
USB .....	48	<b>troubleshooting</b> .....	<b>a</b>
		<b>index</b> .....	<b>e</b>

# introducing your device

In this section, learn about your mobile device's layout, keys, and icons.

## Unpack

---

Check your product box for the following items:

- Mobile device
- Battery
- Travel adapter (charger)
- Headset
- PC data cable
- safety and usage information



- The items supplied with your device may vary depending on the software and accessories available in your region or offered by your service provider. You can obtain additional accessories from your local Samsung dealer.
- The supplied accessories perform best for your device.

## Device layout



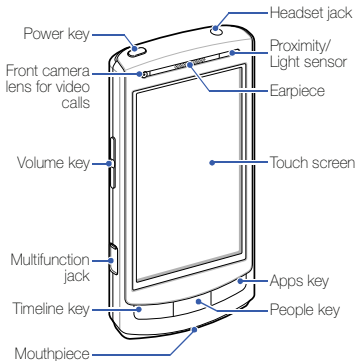

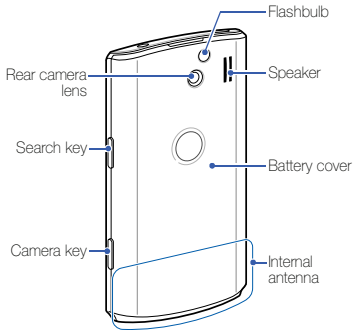

The front of your device includes the following keys and features:



The rear of your device includes the following keys and features:



## Keys

Key	Function
	Turn the device on and off (press and hold); Activate Sleep mode
	Access Timeline view; Switch between list view and tile view; Open the dialling screen (press and hold)
	Access People view; Switch between list view and tile view
	Access Apps view; Switch between list view and grid view
	Adjust the device's volume; Activate or deactivate the Silent profile (press and hold the Volume key down); During an incoming call, mute the call ringer
	Launch the search application (press and hold)

## Key



Turn on the camera (press and hold); In Camera mode, take a photo or record a video

## Icons

Learn about the icons that appear on your display.

### Icon

### Definition



Signal strength



GPRS network connected



EDGE network connected



UMTS network connected















HSDPA network connected



GPS connected

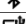

Browsing the web (  appears when Wi-Fi is activated)

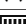
Icon	Definition
	Connected to secured web page ((•) appears when Wi-Fi is activated)
	Alarm activated
	New text message (SMS)
	New multimedia message (MMS)
	New voicemail message
	New email message
	Call diverting activated
	Roaming (outside of normal service area)
	Radio on
	Bluetooth activated
	Connected to PC
	Memory card inserted
	Wi-Fi activated
	Battery power level



# getting started with your device

## Assemble and prepare your device

---

Get started by assembling and setting up your mobile device for its first use.

### Install the SIM or USIM card and battery

When you subscribe to a cellular service, you will receive a Subscriber Identity Module (SIM) card with subscription details, such as your personal identification number (PIN) and optional services.

To use UMTS or HSDPA services, you can purchase a Universal Subscriber Identity Module (USIM) card.

To install the SIM or USIM card and battery,

1. Remove the battery cover.

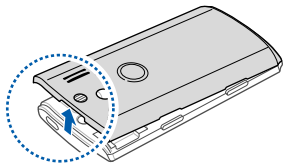

If the device is on, press and hold [⏻] to turn it off.

2. Insert the SIM or USIM card.

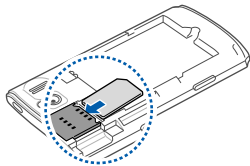

- Place the SIM or USIM card in the device with the gold-coloured contacts facing down.
- Without inserting a SIM or USIM card, you can use your device's non-network services and some menus.

3. Insert the battery.

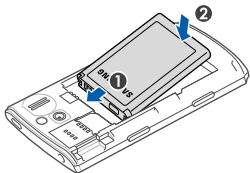

4. Replace the battery cover.

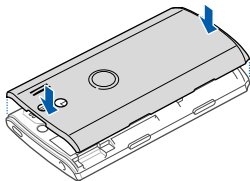

## Charge the battery

Before using the device for the first time, you must charge the battery.

1. Open the cover to the multifunction jack on the side of the device.
2. Plug the small end of the travel adapter into the multifunction jack.

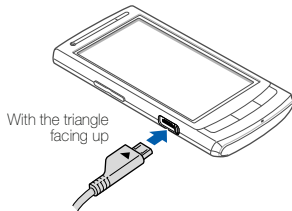

Improperly connecting the travel adapter can cause serious damage to the device. Any damages by misuse are not covered by the warranty.

3. Plug the large end of the travel adapter into a power outlet.
4. When the battery is fully charged (the  icon is no longer moving), unplug the travel adapter from the power outlet.
5. Unplug the travel adapter from the device.
6. Close the cover to the multifunction jack.



#### About the low battery indicator

When your battery is low, the device will emit a warning tone and a low battery message. The battery icon will also be empty and blinking. If the battery level becomes too low, the device will automatically power off. Recharge your battery to continue using your device.

## Insert a memory card (optional)

To store additional multimedia files, you must insert a memory card. Your device accepts microSD™ or microSDHC™ memory cards up to 16 GB (depending on memory card manufacturer and type).



Formatting the memory card on a PC may cause incompatibility with your device. Format the memory card only on the device.

1. Remove the battery cover.
2. Insert a memory card with the label side facing down.

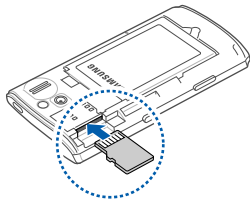

3. Push the memory card in the memory card slot until it locks in place.
4. Replace the battery cover.

To remove the memory card, remove the battery cover, push it gently until it disengages from the device, and then pull the memory card out of the memory card slot.



If you are transferring data, do not remove the memory card. Otherwise, your memory card may be damaged and the data may be corrupted or erased.

## Turn your device on and off

To turn your device on, press and hold [⓪]. Your device will automatically connect to the cellular network.



Vodafone 360 provides extended internet services to connect you to the people and things around you. First, you must log in to Vodafone 360. If you do not have a Vodafone 360 account, sign up for an account.

To turn your device off, press and hold [⓪] again.

## Lock or unlock the touch screen and keys

You can lock the touch screen and the keys to prevent any unwanted device operations. When you press [⓪], your device activates Sleep mode and locks the touch screen and keys.

To unlock, drag your finger on the bottom left of the screen to the right side.

## Activate the Silent profile

To activate the Silent profile, press and hold the Volume key down.



You can also touch the top of the screen to open the status bar and then select **Phone profile** → **Silent**.

## Disable wireless functions

By disabling wireless functions, you can use your device's non-network services in areas where wireless devices are prohibited, such as aeroplanes and hospitals.

To disable wireless functions, touch the top of the screen to open the status bar and then select **Phone profile** → **Flight**.



Follow all posted warnings and directions from official personnel when in areas where wireless devices are prohibited.

## Use the touch screen

---

Your device's touch screen lets you easily select items or perform functions. Learn basic actions to use the touch screen.



For the optimal use of the touch screen, remove the screen protection film before using your device.

- Touch an icon to open a menu or launch an application.

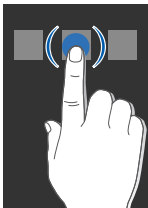

- Drag your finger up or down to scroll through vertical lists.

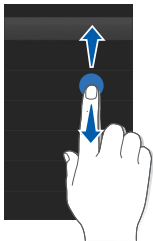

- Drag your finger left or right to scroll through horizontal lists.

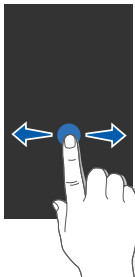

## Switch your device's modes

---

Your device has three modes; Timeline view, People view, and Apps view.

### People view

From any screen, press [] to switch to People view. Your contacts appear in 3D view. When you press [] again, the view mode changes to 2D view.

People view displays all of the saved contact cards with their profile photos, status updates. You can manage contact cards by groups and search for contacts. ► p. 36

When you are logged in to Vodafone 360, you can invite Vodafone 360 contacts to your personal network and connect to them easily. You can share the presence status or location information, share photos, and chat with them.

### Timeline view

From any screen, press [] to switch to Timeline view.

Your device records call log, message log, and other communication history in Timeline view.

### Apps view





From any screen, press [] to switch to Apps view.

Apps view provides you access to applications and features available on your device. You can switch between the list view and the grid view.



## Access applications

Learn to access your device's applications from Apps view.

### Open applications



1. Press  to switch to Apps view.
2. Select an application.
3. Select  to return to the previous screen; Press  or select  to close the current application and return to Apps view.

### Change the location of an application icon

1. Press  to switch to Apps view.
2. Press  again to access the grid view (if necessary).
3. Select .

4. Touch and hold an icon and drag to the location you want.
5. When you are finished, select .

### Remove downloaded applications

1. Press  to switch to Apps view.
2. Press  again to access the list view (if necessary).
3. Select .
4. Select  or  next to the application you want to uninstall.



You cannot uninstall default applications on your device.

## Open the status bar

---

The status bar also displays the status of the currently running applications, such as playing music, and notifications for missed calls, new messages, or missed calendar events and other event alerts. You can also open the dialling screen or change the phone profile on the status bar.

To open the status bar, touch the top of the screen.

## Download applications from Shop

---

Shop provides an easy and quick way to shop for mobile applications. You can extend your device's functionality by downloading and installing additional applications.

To download applications,

1. Press  to switch to Apps view.
2. Select **Shop**. You are connected to the Shop.
3. Search for an application you want to download.
4. Select **Download**.

## Enter text

---

With your device's touch screen, you can enter text and create messages or notes.

When you touch a text input field, your device will show an input panel at the bottom of the screen. To hide an input panel, select .





- To change the input panel, select  → **Qwerty** or **Keypad**.
- To change the input language, select  → **Language** → a language.

- To activate Predictive mode, select  → **XT9 On**. When Predictive mode is activated, your device attempts to predict the word you are entering to save your time and keystrokes.

## Enter text using the qwerty keyboard

Touch buttons you want on the input panel.



You can also use the following icons:

Icon	Function
	Change the case
	Insert a space
	Switch between Number/Symbol mode and ABC mode
	Start a new line
	Delete characters; Clear the input field (touch and hold)

## Enter text using the virtual keypad

Touch a button until the character you want appears.

You can also use the following icons:

Icon	Function
	Insert a space
	Switch between Number/Symbol mode and ABC mode
	Delete characters; Clear the input field (touch and hold)

## Customise your device

Get more from your device by customising it to match your preferences.

### Change the phone profile

Your device includes preset profiles that control the behaviour of incoming calls and messages and phone sounds. You can activate profiles for different situations and personalise profiles.

#### Activate a profile

1. Press [⋮] to switch to Apps view.
2. Select **Settings** → **Phone profile**.
3. Select a profile.

#### Personalise a profile

1. Press [⋮] to switch to Apps view.
2. Select **Settings** → **Phone profile**.

3. Select  next to the profile you want.
4. Change the settings as desired.



Available settings may vary depending on the selected profile.

### Select a wallpaper for the idle screen

1. Press [⋮] to switch to Apps view.
2. Select **Settings** → **Display and light** → **Wallpaper**.
3. Select an image.

### Change the display theme colour

1. Press [⋮] to switch to Apps view.
2. Select **Settings** → **Display and light** → **Theme colour settings**.
3. Select a colour.

## Lock your device

1. Press [⌘] to switch to Apps view.
2. Select **Settings** → **Security** → **Power-on lock**.
3. Enter the default password and select .



- The default password is **00000000**. You can change the default password by selecting **Change password**.
- Samsung is not responsible for any loss of passwords or private information or other damages caused by illegal software.

## Search for data

Use the search application to search for any specific data stored in your device or on a memory card (including contacts, media files, schedules, or messages), or on the web.

1. Press and hold the Search key.
2. Select a search category.
  - **Google**: Search the web with Google
  - **Shop**: Search the Shop
  - **Vodafone 360 members**: Search for your Vodafone 360 contacts
  - **My phone**: Search inside the device
  - **Memory card**: Search a memory card (if a memory card is inserted)
3. Select the text input field and enter a letter or a word of the data to search. Any data including the letter or word you have entered will be listed.
4. Select the data you want to access.

# communication

Your device allows you to send and receive many types of messages over cellular networks and the internet.

## Calling





---

Learn to make or answer calls and use call functions.





When you put your device close to your ear during a call, your device automatically locks the touch screen to prevent accidental inputs.

## Make a call

1. Press and hold [] to open the dialling screen.
2. Enter an area code and a phone number.
3. Select  to dial the number.  
For a video call, select .
4. To end the call, press and hold [].

## Answer a call

1. When a call comes in, press [.
2. For a video call, press [] and select  to allow the caller to see you.
3. To end the call, select **End**.

## Adjust the volume

To adjust the volume during a call, press the Volume key up or down.

## Use the speakerphone feature

1. During a call, select **Speaker on** to activate the speaker.
2. To switch back to the earpiece, select **Speaker off**.





In noisy environments, you may have difficulty hearing the calls while using the speakerphone feature. For better audio performance, use the normal mode.

## View and dial missed calls



Your device will display calls you have missed on the display. To dial the number of a missed call,

1. Touch the top of the screen to open the status bar.
2. Select the missed call field. The missed call list appears.
3. Select the missed call you want to dial and select .

## Call a recently dialed number



1. Press [.
2. Select the name or number you want to dial and select .

## Call an international number

1. Press and hold [] to open the dialling screen.
2. Touch and hold **0** to insert the + character.
3. Enter the complete number you want to dial (country code, area code, and phone number), and then select .

## Call a number from Contacts

You can call numbers directly from Contacts using stored contacts. ► p. 37

1. Press [] to switch to People view.
2. Select the contact you want to dial and select .

## Hold a call or retrieve a held call

Select **Hold** to place a call on hold, or select **Retrieve** to retrieve a held call.

## Dial a second call

If your network supports this function, you can dial another number during a call:

1. During a call, select **Dialler**, enter the second number to dial, and then select . The first call is automatically placed on hold.
2. Select **Swap** to switch between the two calls.
3. To end a call, select the call you want to end and select **End**.

## Answer a second call

If your network supports this function, you can answer a second incoming call:

1. During a call, press [] to answer the second call.
2. Select **Hold active call** to place the first call on hold, or select **End active call** to end the first call.

3. Select **Swap** to switch between the two calls.





## Make a multiparty call (conference call)

1. Call the first party you want to add to the multiparty call.
2. While connected to the first party, call the second party.  
The first party is automatically placed on hold.
3. When connected to the second party, select **More** → **Merge**.
4. Repeat steps 2 and 3 to add more parties (if necessary).
5. To have a private conversation with one party, select **Split**.







## Text and multimedia messages

Use messaging functions. For instructions on entering text, ► p. 14.

### Send a text message

1. Press [] → **Messaging**.
2. Select .
3. Select the recipient field and enter a recipient number.  
You can select a contact from Contacts by selecting .
4. Select the text input field and enter your message.
5. Select  to send the message.

## Send a multimedia message

1. Press  → **Messaging**.
2. Select .
3. Select the recipient field and enter a recipient number or address.  
You can select a contact from Contacts by selecting .
4. Select the text input field and enter your message.
5. Select  → **Add subject** and enter a subject (if necessary).
6. Add media files by using the following icons:
  - : Add files to the message.
  - : Add files as attachment.
7. Select  to send the message.

## View text or multimedia messages

1. Press  → **Messaging**.
2. Select  → **Inbox**.
3. Select a text or multimedia message.

## Voicemails

---

If your voicemail number is preset by your service provider, you can touch and hold **1** to access your voicemail from the dialling screen.

If the voicemail number is not preset or if you need to change the voicemail number,

1. Press  → **Messaging**.
2. Select  → **Settings** → **Voicemail number**.
3. Select the input field.
4. Enter the voicemail number provided by your service provider.

## Email messages

---

You can retrieve new email messages from other web accounts to your device by using the Vodafone 360 service. When you launch the email application, the email accounts you have registered appear. Select an email account you want to retrieve messages from.

To launch the email application, press [☰] → **Email.**

## Chat

---

You can send and receive instant messages (IM) by using the chat application. Before sending or receiving instant messages, you must log in to Vodafone 360.

To launch the chat application, press [☰] → **Chat.**



# media

Learn to listen to music, capture photos and videos, and take advantage of your device's multimedia features.

## Music

---

Learn how to listen to music via the music player. Music files are categorised in folders by artist, album, track, genre, and playlist.

### Add music files to your device

Start by adding files to your device or memory card:







- Download from Music Shop.
- Download from a PC with the optional Samsung PC Studio. ► p. 49
- Synchronise with Windows Media Player 11. ► p. 49
- Copy music files to your memory card. ► p. 50
- Receive via Bluetooth. ► p. 48



### Download music files from Music Shop

1. Press [  ] → **Music** → **Music Shop**.
2. Search for music files and download them to your device.







## Play music files

1. Press [] → **Music** → **My Library**.
2. Select a music category → a music file.  
You can select **Shuffle tracks** to play music files in the random order.
3. During playback, use the following icons:

Icon	Function
	Activate Shuffle mode
	Change the repeat mode (repeat once/repeat all/repeat off)
	Skip to the previous file; Scan backward in a file (touch and hold)
	Pause playback
	Resume playback
	Skip to the next file; Scan forward in a file (touch and hold)
	Rate the current track

Icon	Function
	Open the track list
	Add the currently playing track to the On-the-go playlist
	Recommend the current track to your friends

## Create a playlist

1. Press [] → **Music** → **My Library** → **Tracks**.
2. Select .
3. Select the files you want to add to a playlist.
4. Select .
5. Select  →  to return to the library screen.
6. Select **Playlists** → **On-the-go playlist**.
7. Select .

8. Enter a name for the playlist and select **OK**.
9. Select **Clear** to remove the tracks from the On-the-go playlist (if necessary).

## Camera

Learn to capture and view photos and videos.



If you are logged in to Vodafone 360, your device will automatically upload captured photos to the Vodafone 360 server.

To upload photos to the server manually, select .

## Capture photos

1. Press and hold the Camera key to turn on the camera.
2. Rotate the device anti-clockwise to landscape view.
3. Aim the lens at the subject and make any adjustments.





4. Press the Camera key to take a photo. The photo is saved automatically.
5. Select  to take another photo (step 3).



## View photos

1. From the viewfinder, select .
2. Scroll to the photo you want.



## Use camera options

Before capturing a photo, use the following icons:



Icon	Function
	Change the shooting mode
	Change the scene mode
	Change the camera settings
	Switch to camcorder
	Turn the flash on or off

Icon	Function
	Adjust the brightness
	View captured photos

## Capture videos







1. Press and hold the Camera key to turn on the camera.
2. Rotate the device anti-clockwise to landscape view.
3. Select  to switch to Recording mode.
4. Aim the lens at the subject and make any adjustments.
5. Press the Camera key to start recording.
6. Select  or press the Camera key to stop recording.  
The video is saved automatically.
7. Select  to record another video (step 4).

## View videos

1. From the viewfinder, select .
2. Scroll to the video you want.
3. Select  to play the video.

## Use camcorder options

Before capturing a video, use the following icons:

Icon	Function
	Change the recording mode
	Change the camera settings
	Switch to camera
	Turn the flash on or off
	Adjust the brightness
	View captured video clips

## Capture photos by using options preset for various scenes

1. Press and hold the Camera key to turn on the camera.
2. Rotate the device anti-clockwise to landscape view.
3. Select  → a scene.
4. Make any necessary adjustments.
5. Press the Camera key to take a photo.

## Capture a series of photos

1. Press and hold the Camera key to turn on the camera.
2. Rotate the device anti-clockwise to landscape view.
3. Select  → **Continuous**.

4. Make any necessary adjustments.
5. Press and hold the Camera key to take a series of photos.

## Capture mosaic photos

1. Press and hold the Camera key to turn on the camera.
2. Rotate the device anti-clockwise to landscape view.
3. Select  → **Mosaic**.
4. Select an image layout
5. Make any necessary adjustments.
6. Press the Camera key to take photos for each segment.

## Capture photos with decorative frames

1. Press and hold the Camera key to turn on the camera.
2. Rotate the device anti-clockwise to landscape view.
3. Select  → **Frames**.
4. Select a frame.
5. Make any necessary adjustments.
6. Press the Camera key to take a photo with the frame.

## Capture panoramic photos

1. Press and hold the Camera key to turn on the camera.
2. Rotate the device anti-clockwise to landscape view.

3. Select  → **Panorama**.
4. Make any necessary adjustments.
5. Press the Camera key to take the first photo.
6. Slowly move the device to a direction you want. The device captures the next photo automatically.
7. Repeat step 6 to complete the panoramic photo.

## Capture photos in Smile shot mode

1. Press and hold the Camera key to turn on the camera.
2. Rotate the device anti-clockwise to landscape view.
3. Select  → **Smile**.
4. Press the Camera key.

5. Aim the camera lens at your subject.  
Your device recognises people in an image and detects their smiles. When the subject smiles, the device automatically takes a photo.

## Gallery

---

Learn to view your photos and videos and edit photos.

### View a photo or video

1. Press [⋮] → **Gallery**.
2. Select a tab.
  - **All:** Display all photos and videos saved in your device.
  - **Camera roll:** Display photos and videos you captured with your device.
  - **Albums:** Display photo albums you created on your device.

3. Select a photo or video.











- You can touch the photo display twice to enter the zoom screen. Drag up or down on the right of the screen.
- You can view photos as a slideshow by selecting .

### Create an album

1. Press [⋮] → **Gallery** → **Albums**.
2. Select .
3. Select the text input field.
4. Enter a name for the new album.
5. Select and drag files to the **Selected** list.
6. When you are finished, select to save the album.

## Edit a photo

1. Press  → **Gallery** → a photo.
2. Select .
3. Use the following editing options to edit the photo:



Option	Function
Tools	<ul style="list-style-type: none"> <li>• : Draw a sketch or add shapes</li> <li>• : Add a text</li> </ul>
Adjust	<ul style="list-style-type: none"> <li>• : Rotate, flip, or crop an image, or change the image size</li> <li>• : Adjust the brightness, contrast, or saturation</li> <li>• : Apply various special effects</li> <li>• : Apply various image styles</li> </ul>

4. When you are finished, select  → **Save**.



## Share photos

You can share photos with Vodafone 360 all connected. You can view the shared photo of Vodafone 360 all connected in the contact view. In the Me view, you can view and unshare photos you shared.

### Share with Vodafone 360 all connected

1. Press  → **Gallery**.
2. Select and open a photo.
3. Select .
4. Select **Vodafone 360 all connected**.

### Share with a social network

1. Press  → **Gallery**.
2. Select and open a photo.
3. Select .
4. Select one from the registered social network domains.

## My Files

---

Learn to view and access all the files and folders on your device or a memory card.





If you access this menu before loading data from a memory card, your device will not display all files.

### Open a file

1. Press [  ] → **My Files**.
2. Select a folder (if necessary).
3. Select a file you want.

### Copy or move files

1. Press [  ] → **My Files**.
2. Select a folder.
3. Select .

4. Select the check boxes next to the files you want to copy or move.
5. Select  or .
6. Locate where the files are copied or moved.
7. Select .

### Edit file names

1. Press [  ] → **My Files**.
2. Select a folder.
3. Select .
4. Touch the name of the file you want to rename.
5. Edit the file name.



## Radio

Learn to listen to your favourite radio stations.



You must connect the headset to your device to listen to the radio. The headset serves as a radio antenna.



### Listen to the radio

1. Plug the supplied headset into the device's headset jack.
2. Press [  ] → **Radio**.
3. Select < or > to scan through available radio stations.
  - To adjust the volume, press the Volume key.
  - To change the sound output, select .



When you unplug the headset from the device, the radio turns off.



## Save radio stations by automatic tuning

1. Press [  ] → **Radio**.
2. Select  to open the station list.
3. Select .
4. Select **Continue**.  
The radio scans and saves available stations automatically.
5. Select a station you want to listen to.

## Set up your favourite radio station list

1. Press [  ] → **Radio**.
2. Select < or > to select the radio station you want to save.
3. Select  at the bottom of the screen.







## Record the radio

1. Press  → **Radio**.
2. Select  to begin recording.
3. When you are finished recording, select .



## Voice Recorder





Learn to operate your device's voice recorder.

### Record a voice memo

1. Press  → **Voice Recorder**.
2. Select  to begin recording.
  - To pause, select .
  - To resume, select .
3. When you are finished recording, select .
4. Select  to save the voice clip.

## Play a voice memo

1. Press  → **Voice Recorder**.
2. Select  → a voice clip.
3. During playback, use the following icons:

Icon	Function
	Skip to the previous file; Scan backward in a file (touch and hold)
	Pause playback
	Resume playback
	Skip to the next file; Scan forward in a file (touch and hold)

## PC Studio

---

Samsung PC Studio is a Windows-based program that allows you to manage your personal information and sync files to your device.

### Install Samsung PC Studio

1. Press [⌨] → **Settings** → **Phone settings** → **USB setting** → **Install PC studio**.
2. Connect your device to a PC via the USB port.
3. If Samsung PC Studio is not installed on the PC and the PC is connected to the internet, you will be prompted to install the program.
4. When the installation is complete, Samsung PC Studio automatically launches.

If Samsung PC Studio does not automatically run, open **My Computer** and double-click **NPS Auto Installer** and then the NPSAI.exe file.



- If Samsung PC Studio is installed on a PC, the corresponding Samsung USB drivers will be automatically installed.
- You can also download the Samsung PC Studio program from the Samsung website ([www.samsungmobile.com](http://www.samsungmobile.com)).

### Use Samsung PC Studio

To connect your phone to a computer with PC Studio, you must change the phone's USB mode. ► p. 49

# personal productivity





Learn to manage contacts, schedule calendar events, create notes, and use the file viewer.

## Contacts



---

Learn to use contact cards and groups to store personal information, such as names, phone numbers, and addresses.



### Add a new contact

1. Press .
2. Select .
3. Complete the fields.
  - To add a caller ID image, touch the tile  image next to the name field and capture a new photo or select one from **My Files**.
  - To add contact information, select  → a detail item.
4. When you are finished, select .  
If you want to cancel adding a new contact, press any key on the front of the device.





## Import contacts from the SIM or USIM card

1. Press .
2. Select  → **Contacts setting**.
3. Select **Import SIM contacts**.
4. Select **OK**.



## Find a contact

1. Press .
2. Select .
3. Enter the first few letters of the name you want to find.
4. Select the contact's name from the search list.
5. Select  to edit the contact information.

## Create a contact group

1. Press .
2. Select  → **Manage groups**.
3. Select .
4. Enter a group name.  
To change the colour assigned to the group, select .
5. Select and drag a contact to the **Selected** list to add members to the new group.
6. When you are finished, select .

## Invite a contact to connect

1. Press .
2. Select a contact.
3. Select , or select  → **Invite**.

4. Enter an invitation message and select  to send the message.

When the contact accepts the connection invitation, your device will notify you.

## Calendar

Use the calendar to keep track of your monthly, weekly, daily schedule.

### Change the calendar view

1. Press  → **Calendar**.  
The calendar opens in month view.
2. Select a tab to change the calendar view.
  - **Events:** a list of scheduled events
  - **Day:** hourly blocks for one full day
  - **Week:** hourly blocks for the days in one full week
  - **Month:** a full month in one view



To go to a specific date, select  and touch the month or year field.

### Create an event

1. Press  → **Calendar**.
2. Select  → an event type (appointment, anniversary, birthday).



If you touch an empty field in the week or day view, your device will prompt you to create an event.



3. Complete the fields and adjust the settings for your event.
4. When you are finished, select .

### View an event

To view events of a specific date,

1. Press  → **Calendar**.
2. Select a date on the calendar.  
A list of the events saved on the date appears at the bottom of the calendar.
3. Select an event to view its details.





To view events by event types,

1. Press  → **Calendar** → **Events** tab.
2. Select  → an event type.
3. Select an event to view its details.

## File Viewer





Use the file viewer to view Word, PowerPoint, Excel, PDF, and text files.

### Open a file

1. Press  → **File Viewer**.
2. Select a file.
3. While viewing the document, use the following features:
  - Select  or  to move between pages.
  - Select  to go to specific page.

- Touch the display to view in full screen mode; To exit full screen mode, touch the display again.
- Touch the display twice and then drag up (zoom in) or down (zoom out).



### Find a word from a document

1. Press  → **File Viewer**.
2. Select a file.
3. Select  → **Search for word**.
4. Enter the word to find and select . The word found will be highlighted in the document.
5. To find another word, select .

## Notes

---

Use Notes to create notes.

1. Press [  ] → **Notes**.
2. Select  to create a new note.
3. Enter your note with the input panel.
4. When you are finished, select .









# web applications

## Internet

---



Learn to access and bookmark your favourite web pages.

### Browse a web page

1. Press  → **Internet**.  
Your service provider's homepage opens.
2. Access a web page:
  - Select the address bar and enter a web address.
  - Select  → a bookmark.
  - Select  → **History** → a web address.
3. While browsing web pages, use the following features:
  - To move backward or forward on a web page, select  or .
  - To reload a web page, select .

## Open multiple pages

You can open multiple pages and switch back and forth between them.

1. Press  → **Internet**.
2. Select  → **Multi window**.
3. Touch the empty page.  
A new blank window opens.
4. Access another web page on the new window.
5. To switch back and forth between currently open windows, select  → **Multi window** and select a web page to retrieve.

## Bookmark your favourite pages

1. Press  → **Internet**.
2. Select  → .
3. Enter a name and web address.



4. Select a folder to save the bookmark.  
You can add a new folder by selecting **Add to** → **New folder**.
5. When you are finished, select .

## Web Player

---

Use Web Player to add streaming internet links and play videos or audio files linked to the internet.

### Add a streaming internet link

1. Press  → **Web Player**.
2. Select .
3. Enter a name and web address and select .

## Play streaming media files

1. Press  → **Web Player**.
2. Select a link you want.  
The web player opens and starts playing the file.

## RSS



---

Use the RSS application to get the latest news and information from your favourite websites.





### Subscribe to RSS feeds

1. Press  → **RSS**.
2. Select .
3. Enter the title and address of an RSS feed and select .





### Update and read RSS feeds

1. Press  → **RSS**.
2. Select  next to the RSS feed you want to update.  
Your device will attempt to connect to the internet. If necessary, activate your internet connection.
3. Select a feed and a link.

### Export RSS feeds

1. Press  → **RSS**.
2. Select  → **Export feed list**.
3. Select and drag a feed to the **Selected** list.
4. Select .
5. Enter a file name and select .

## Import RSS feeds

1. Press  → RSS.
2. Select  → **Import feed list.**
3. Select a feed from the list.
4. Select the check box next to the feed you want to import and select .
5. Select a folder where the feed is saved and select .



# connectivity

Learn to connect to a wireless LAN, transfer data to and from your device via the Bluetooth wireless feature or USB, and use your device as a wireless modem.

## Wi-Fi

---

Your device features wireless networking capabilities that allow you to connect to wireless local area networks (WLANs).



This device uses non-harmonised frequency and is intended for use in all European countries.

The Wi-Fi can be operated in the EU without restriction indoors, but cannot be operated outdoors in France.

## Activate and connect to a Wi-Fi

1. Press  → **Wi-Fi**.
2. Touch the device icon at the bottom of the screen.
3. Select .
- The device starts searching and displays available Wi-Fi networks.
4. Drag a network icon to the device icon at the bottom of the screen.

5. Enter a password and select  (if necessary).  
The device will attempt to connect to the Wi-Fi.





## Create a new Wi-Fi connection

1. Press  → **Wi-Fi**.
2. Select .
3. Select .
4. Enter a network name and configure connection settings.
5. When you are finished, select .  
The Wi-Fi network will appear on the Wi-Fi connection list.



You can also add Wi-Fi connections by selecting one from the searched connections. From the Wi-Fi connection list, select  →  → a network.

## Set up the favourite connection list

1. Press  → **Wi-Fi**.
2. Select .
3. Select .
4. Select **Edit favourites list**.
5. Drag a Wi-Fi connection to the **Selected** list.
6. When you are finished, select .



## Bluetooth

You can connect with other Bluetooth-enabled wireless devices within a range. Walls or other obstacles between devices may block or impair the wireless connection.

## Turn on the Bluetooth wireless feature

1. Press  → **Bluetooth**.
2. Touch the slide bar next to **My Bluetooth** to turn on the Bluetooth wireless feature.
3. To allow other devices to locate your device, select  → **My phone's visibility** → an option for a duration that your device is visible.

## Search for and register a Bluetooth-enabled device

1. Press  → **Bluetooth**.
2. Select .  
Your device searches for and displays the list of Bluetooth-enabled devices.
3. Select a device name.

4. Enter the Bluetooth PIN for the device you are trying to connect to and select .  
When the owner of the other device enters the same PIN or accepts the connection, registering is complete.



To register another Bluetooth-enabled device, both devices must use the same passcode. Headsets or hands-free car kits may use a fixed PIN, such as **0000**.

## Send data via the Bluetooth wireless feature

1. Locate an item or a file to send.
2. Select a sending option.
3. Select a registered device.

## Receive data via the Bluetooth wireless feature

1. When another device attempts to access yours, select **Yes** to permit the connection (if necessary).
2. Select **Yes** again to confirm that you are willing to receive data from the device (if necessary).

## Activate Remote SIM mode

In Remote SIM mode, you can make or answer calls only with a connected Bluetooth hands-free car kit via the SIM or USIM card on your device.

To activate Remote SIM mode,

1. Press [  ] → **Bluetooth**.
2. Select .
3. Select **Remote SIM mode**.

To use Remote SIM mode, start the Bluetooth connection from a Bluetooth hands-free car kit.



The Bluetooth hands-free car kit must be authorised. To authorise the car kit, touch and hold it from the device list and select .

## USB

You can connect your device to a PC and use various USB modes.



- You must close running applications before connecting your device to a PC.
- While connected to a PC, you will not access network-based menus and use the network features, such as calls and messages.

## Set a default action for your USB connection

When the **Ask on connection** setting (by default) is selected for USB connection, your device will prompt you to choose the USB mode every time you connect to a PC.

To set your device to perform a default action when you connect the device to a PC with the PC data cable,

1. Press [⋮] → **Settings** → **Phone settings** → **USB setting**.
2. Set the default USB mode (**Samsung PC studio**, **Media player**, **Mass storage**, **PC Internet**, or **Install PC studio**).

## Use Samsung PC Studio

1. Press [⋮] → **Settings** → **Phone settings** → **USB setting** → **Samsung PC studio**.

2. Press [⋮] to close running applications and return to Apps view.
3. Connect your device to a PC via the USB port.
4. Run Samsung PC Studio and copy files from the PC to the device.

## Synchronise with the Windows Media Player

1. Press [⋮] → **Settings** → **Phone settings** → **USB setting** → **Media player**.
2. Press [⋮] to close running applications and return to Apps view.
3. Connect your device to a PC with Windows Media Player installed via the USB port.
4. Open Windows Media Player to synchronise files.

5. Edit or enter your device's name in the pop-up window (if necessary).
6. Select and drag the files you want to the sync list.
7. Start synchronisation.

## Copy files to a memory card

1. Insert a memory card.
2. Press [⌘] → **Settings** → **Phone settings** → **USB setting** → **Mass storage**.
3. Press [⌘] to close running applications and return to Apps view.
4. Connect your device to a PC via the USB port.
5. Select **Phone** or **Memory card**.
6. Open the folder to view files.

7. Copy files from the PC to the memory card.



When you disconnect your device from a PC, the device updates the internal database. While updating, you will not access some menus, such as **My Files** or **Gallery**.



If you remove or edit MMS and email data in `./message` or `./email` through a PC when connected to the mass storage of your device, the data may be corrupted and you cannot open multimedia or email messages. If the mass storage is full, messages may not be received.

## Use internet sharing

Learn to use your device as a wireless modem and connect your PC to the internet over the Vodafone high-speed mobile phone network.

1. Press [⌘] → **Settings** → **Phone settings** → **USB setting** → **PC Internet**.
2. Press [⌘] to close running applications and return to Apps view.
3. Connect your device to a PC via the USB port.
4. When the installation manager appears, follow the on-screen instructions to complete the installation of the software.
5. Once the installation is complete, the Vodafone Mobile Connect via the phone window will appear.  
If Vodafone Mobile Connect via the phone does not automatically run, open **My Computer** and double-click **Samsung Mobile** and then the VTP\_Manager.exe file.
6. Activate the internet connect via the Vodafone network.

# additional programs



Learn to use Alarm, World clock, Calculator, Units, Stopwatch, Card Scanner, and Maps.

## Alarm



---

Learn to set and control alarms for important events.

### Set a new alarm

1. Press  → **Alarm**.
2. Select .
3. Set alarm details in each field.
4. When you are finished, select .

### Delete an alarm

1. Press  → **Alarm**.
2. Select .
3. Select the check boxes next to the alarm names you want to delete.
4. Select  → **OK**.



To deactivate an alarm, touch the slide bar next to an alarm name on the list.

## World Clock

Learn to add world clocks and monitor the time in other regions.

### Add a world clock

1. Press  → **World Clock**.
2. Select .
3. Enter the name of the city or country you want to add.
4. Select the city from the result list.



- To set daylight saving time, touch **DST** on the right of a world clock on the list.
- To change the city, touch a world clock on the list and enter the city name you want.

### Delete a world clock



1. Press  → **World Clock**.
2. Select .
3. Select the check boxes next to the city or country names you want to delete.

4. Select  → **OK**.

## Calculator

Use the calculator to perform mathematical calculations.



To perform a calculation,

1. Press  → **Calculator**.
2. Enter the first number using the calculator buttons on the screen.
3. Select the appropriate math function.
4. Enter the second number.
5. To view the result, select .



- To clear the last digit entered in a multi-digit entry, select .
- To clear the displayed numbers, select .

You can use the following icons while using calculator:

- : Use advanced mathematical functions
- : Clear, save, or recall values
- : Switch to the converter

## Units

---

Use the converter application to convert one unit of measure to another.





To perform a conversion,

1. Press [] → **Units**.
2. Select a type of measurement.
3. Select the first line and select the unit of measure to convert.
4. Select the input field and enter the base amount.  
The device displays the conversion result.

## Stopwatch

---

Use the stopwatch to measure the length of time.



1. Press [] → **Stopwatch**.
2. Select .
3. Select  to record lap times.
4. When you are finished, select .
5. Select  to clear the recorded times.

## Card Scanner

---

Use the card scanner to capture information from a business card.

1. Press [] → **Card Scanner**.
2. Rotate the device anti-clockwise to the landscape orientation.
3. Align the corners of the card with the corners of the frame.

- When aligned, the frame will turn coloured and your device will automatically capture the image.
- When recognising is completed, touch each field and edit contact information (if necessary).
- Select  to save the information as the contact card.
- Select  to save the contact card.



- For best results, place business cards on a flat, level surface and ensure adequate lighting.
- You can capture images of multiple business cards by selecting .



## Maps

With Maps, you can find your location, search the online map for streets, cities, or countries, and get directions. You can also search the map for your Vodafone 360 connected contacts.

### Search the map



- Press  → **Maps**.
- Drag your finger in the direction you want on the map.

From the map, you can use the following features:





- To zoom in on the location you want, select . To zoom out, select .
- To find your current location, select .

- To create a placemark, touch and hold the location you want on the map. Create and enter the information for the location.

## Search for a specific location

1. Press  → **Maps**.
2. Select .
3. Use one of the following methods:
  - **Search for:** Enter a keyword of interest or business.
  - **Previous searches:** Select a keyword from the previous search list.
  - **Address:** Enter the address of the location.
  - **My places, My contacts, Exchanged places:** Browse My places, My contacts, and Exchanged places.

## Get directions to a specific destination

1. Press  → **Maps**.
2. Select the location you want and open the location details screen.
3. Select .  
The selected location is set as the ending location for the navigation.
4. Select a navigation mode ( for drive or  for walk).
5. Select **Start navigation**.

# settings

Learn about your device settings.

To access your device settings, press [⋮] → **Settings**.

## Vodafone 360

---

Change the settings for using Vodafone 360. You can change the login status to the Vodafone 360 server or set up web accounts for Google, facebook, and other web services. You can also synchronise phone data with a web server, or remove phone data, such as messages, email, contacts, timeline information, and status information stored in your device.

## Phone profile

---

Select a phone profile that controls ringtones for calls and new events, and set device's sounds, such as touch tones.

## Display and light

---

Customise the display and light settings.

- **Brightness:** Adjust the brightness of the screen.
- **Backlight timing:** Set the length of time the screen stays on when the device is not in use.
- **Theme colour settings:** Select a theme colour for the screen.
- **Wallpaper:** Select a background image for the idle screen.

## Time and date

---

Control the appearance and behaviour of the date, time, and time zone.

## Phone settings

---

Customise the general phone settings.

- **Language:** Select a display language for all menus and applications.
- **Text input:** Select an input language for all text editors and set XT9 options.
- **Vibration feedback:** Set to activate or deactivate the vibration feedback on your display touch.
- **USB setting:** Select a USB connection mode used when you connect your device to a PC using the PC data cable.
- **Device light setting:** Turn on or off the LED at the bottom of the device.
- **Licence settings:** Set to manage the licences for your media files.
- **DivX® VOD:** Check the DivX registration code for your device.

## Application settings

---

Customise the application settings.

- **Call:** Change the settings for call functions.
- **Messaging:** Change the settings for message functions.
- **Email:** Change the settings for sending or receiving email.
- **Contacts:** Change the display order and sort order of contact cards in Contacts.
- **Gallery:** Change the option for uploading photos and videos.
- **Radio:** Change the settings for using the radio.

## Network settings

---

Customise the network settings.

- **Select network:** Set the device to automatically select the first available network or select a network manually.
- **Network mode:** Select the network mode.

- **Vodafone connections:** View available connection profiles or add new connection profiles.
- **Preferred networks:** Set up the preferred network list.
- **Data roaming:** Set the device to automatically connect to another network when you are roaming or your home network is not available.

## Security

---

Customise the security settings.

- **Power-on lock:** Lock your device. You will be prompted to enter the password when turning on the device.
- **Prompt if device unused for:** Set a length of time the phone waits for before locking itself when it is not in used. The device will be automatically locked after the specified length of time when the display turns off. You

will be prompted to enter the password when starting to use the device.

- **Change password:** Change your password. The default password is **00000000**.
- **PIN lock:** Lock your SIM or USIM card by activating the PIN requirement. You need to enter the PIN supplied with your SIM or USIM card.
- **Change PIN1 code:** Change the PIN1 code.
- **Change PIN2 code:** Change the PIN2 code.
- **SIM lock:** When this option is enabled, your device only works with the current SIM or USIM card. If you insert an unknown SIM or USIM card, your device will ask for the lock code.

## Memory settings

---

Customise the memory settings.

- **Memory card details:** View the total amount of memory and available memory in a memory card.
- **Default memory:** Set a default memory location for storing media files.
- **Memory status:** View the amount of memory available for storing messages or files.

## Reset settings

---

Set to restore default settings.

## Open source licence

---

View the open source licence information on your device.

# troubleshooting

When you turn on your device or while you are using the device, it prompts you to enter one of the following codes:

Code	Try this to solve the problem:
Password	When the phone lock feature is enabled, you must enter the password you set for the device.
PIN	When using the device for the first time or when the PIN requirement is enabled, you must enter the PIN supplied with the SIM or USIM card. You can disable this feature by using the <b>PIN lock</b> menu.

Code	Try this to solve the problem:
PUK	Your SIM or USIM card is blocked, usually as a result of entering your PIN incorrectly several times. You must enter the PUK supplied by your service provider.
PIN2	When you access a menu requiring the PIN2, you must enter the PIN2 supplied with the SIM or USIM card. For details, contact your service provider.

## The device prompts you to insert the SIM card.

Ensure that the SIM or USIM card is installed correctly.

## Your device does not show a signal (no bars next to the network icon)

- If you just turned on the device, wait about 2 minutes for your device to find the network and receive a signal.
- You may not be able to receive a signal in tunnels or elevators. Move to an open area.
- You may be between service areas. You should receive a signal when you enter a service area.



## You forgot a PIN or PUK

If you forget or lose this or another code, contact the seller or your service provider.

## Your display shows white lines

The display may show white lines if you have turned the device on after a long period of disuse or if you removed the battery without first turning off the device. The display should correct itself in a short time.

## You enter a number, but the call is not dialed

- Ensure that you have selected  or you have pressed and held [].
- Ensure that you have accessed the right cellular network.
- Ensure that you have not set call barring for the phone number.

## You select a contact to call, but the call is not dialed

- Ensure that the correct number is stored in the contact information.
- Re-enter and save the number, if necessary.

### Another caller cannot hear you speaking

- Ensure that you are not blocking the built-in microphone.
- Move the built-in microphone closer to your mouth.
- If using a headset, ensure that it is properly connected.

### The sound quality of a call is poor

- Ensure that you are not blocking the internal antenna on bottom of the device.
- When you are in areas with weak signals, you may lose reception. Move to another area and try again.

### The battery does not charge properly or sometimes your device turns itself off while charging

- Disconnect the device from the charger, remove and reinstall the battery, and try charging again.
- The battery terminals may be dirty. Wipe both gold-coloured contacts with a clean, soft cloth and try charging the battery again.
- If the battery no longer charges completely, dispose of the old battery properly and replace it with a new battery.

### Your device is hot to the touch

When you use applications that require more power, your device may heat up.

This is normal and should not affect your device's lifespan or performance.

## Your device prompts you to delete some data

The available memory is low. Move your data to a memory card or delete old items from applications.

## You cannot find a Bluetooth-enabled device

- Ensure that both devices have activated the Bluetooth wireless feature.
- Ensure that the distance between the devices is not more than 10 metres and that they are not separated by walls or other obstacles.
- Ensure that each device's visibility is activated.
- Ensure that both devices are compatible with Bluetooth wireless technology.

## You cannot listen to music on a remote Bluetooth headset

- Ensure that your device is connected to the headset.
- Ensure that the music format you are trying to listen to is supported by your device.
- Ensure that the distance between the headset and device is within a range and that they are not separated by walls or other obstacles.

# index

## alarms

- creating, 52
- deleting, 52

## applications

- accessing, 13
- downloading, 14
- uninstalling, 13

## apps view 12

## battery

- charging, 7
- installing, 5
- low battery indicator, 8

## Bluetooth

- activating, 47
- receiving data, 48

- remote SIM mode, 48
- sending data, 47

## calculator 53

## calls

- adjusting volume, 19
- answering, 19
- dialling additional calls, 20
- from Contacts, 20
- international numbers, 20
- making, 18
- multiparty call, 21
- placing on hold, 20
- recently dialled, 19
- retrieving held calls, 20
- using speakerphone feature, 19
- viewing missed, 19

## card scanner 54

## chat 23

## conference call

- see calls, multiparty

## contacts

- adding, 36
- creating groups, 37
- finding, 37
- importing from SIM, 37
- inviting to connect, 37

## converter 54

## email messages 23

## file viewer 39

## FM radio

see radio

## gallery

creating photo albums, 31  
editing photos, 31  
viewing photos and videos,  
30

## GPS 3

## internet

adding bookmarks, 42  
launching homepage, 41  
opening multiple pages, 42

## internet sharing 51

## memory card 8

## messages

instant, 23

retrieving email from the web  
23  
sending multimedia, 22  
sending text, 21  
viewing text and multimedia,  
22

## music player

creating playlists, 25  
playing music, 25

## people view 12

## phone lock 16

## photos

basic capturing, 26  
capturing in continuous  
mode 28  
capturing in panoramic mode  
29  
capturing in scene mode 28

capturing in smile shot mode  
29  
capturing with frames 29  
creating photo albums, 31  
editing, 31  
viewing, 26

## radio

automatic tuning, 33  
listening to, 33  
recording, 34  
setting up favourites list, 33

## RSS

exporting feeds, 43  
importing feeds, 44  
subscribing to feeds, 43  
updating and reading feeds,  
43

## search 17

silent profile 9

SIM card 5

stopwatch 54

text

- creating notes, 40
- entering, 14
- messages, 21

timeline view 12

touch screen 10

units

- see converter

USIM card 5

videos

- capturing, 27
- viewing, 27

voice recorder

- playing, 34
- recording, 34

voicemail 22

web browser

- see internet

web player

- adding streaming links, 42
- playing stream, 43

Wi-Fi

- activating, 45
- adding new connections, 46
- setting up favourites list, 46

wireless modem 51

world clock 53

- adding, 53
- deleting, 53



## Declaration of Conformity (R&TTE)

We, **Samsung Electronics**

declare under our sole responsibility that the product

**GSM Mobile Phone : GT-I8320**

to which this declaration relates, is in conformity with the following standards and/or other normative documents.

SAFETY	EN 60950- 1 : 2001 +A11:2004
SAR	EN 50360 : 2001 EN 62209-1 : 2006
EMC	EN 301 489- 01 V1.6.1 (09-2005) EN 301 489- 07 V1.3.1 (11-2005) EN 301 489- 17 V1.2.1 (08-2002) EN 301 489- 24 V1.4.1 (09-2007)
RADIO	EN 301 511 V9.0.2 (03-2003) EN 300 328 V1.7.1 (10-2006) EN 301 908- 1 V3.2.1 (05-2007) EN 301 908- 2 V3.2.1 (05-2007)

We hereby declare that [all essential radio test suites have been carried out and that] the above named product is in conformity to all the essential requirements of Directive 1999/5/EC.

The conformity assessment procedure referred to in Article 10 and detailed in Annex[M] of Directive 1999/5/EC has been followed with the involvement of the following Notified Body(ies):

BABT, Forsyth House-Churchfield Road  
Walton-on-Thames  
Surrey - KT12 2TD - UK\*  
Identification mark: 0168



The technical documentation kept at :  
**Samsung Electronics QA Lab.**

which will be made available upon request.  
(Representative in the EU)

Samsung Electronics Euro QA Lab.  
Blackbushe Business Park, Saxony Way,  
Yateley, Hampshire, GU46 6GG, UK\*

2009. 08. 19

**Yong-Sang Park / S. Manager**

(place and date of issue)

(name and signature of authorised person)

\* It is not the address of Samsung Service Centre. For the address or the phone number of Samsung Service Centre, see the warranty card or contact the retailer where you purchased your product.

Some of the contents in this manual may differ from your device depending on the software of the device or your service provider.

**SAMSUNG ELECTRONICS**



World Wide Web  
<http://www.samsungmobile.com>

Printed in Korea  
Code No.:GH68-28201A  
English. 03/2010. Rev. 3.0