



motorola W180

Getting Started Guide

accessories

Stereo Headset Travel Charger Car Charger



These and other accessories available at:
www.motorola.com

For more information about your phone, please visit:
www.motorola.com/support



getting started

You can download a full user manual by visiting: www.motorola.com/support.

install SIM card & battery

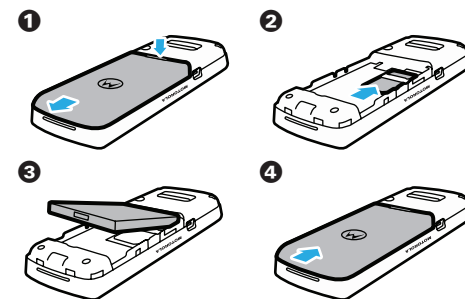

getting started

charge battery

New batteries are not fully charged. To charge your phone's battery, plug the battery charger into your phone and into an electrical outlet. Your phone may take several seconds to start charging the battery.

When charging is finished, your display shows **Charge Complete**.

For tips on battery life and charging, see the Battery Tips section of this guide.

Note: USB charging via PC not supported.

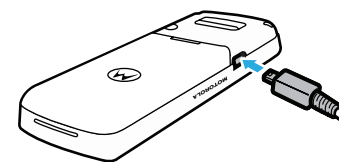

getting started

turn phone on & off

Press and hold **[Power]** for a few seconds, or until the display turns on or off.

make a call

Enter a phone number and press **[Call]**.

answer a call

When your phone rings and/or vibrates, press **[Call]**.

end a call

Press **[End Call]**.

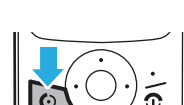
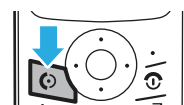
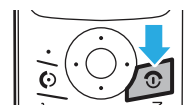

basics

your phone

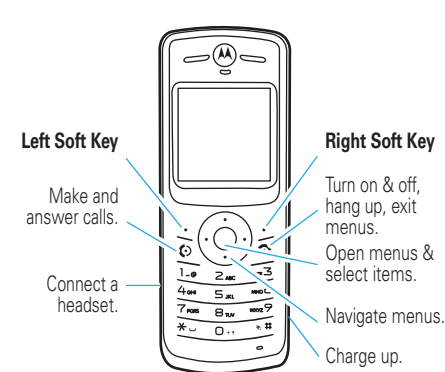

Note: Your phone may not appear exactly as the images in this manual. However, all key locations, sequences and functions are the same.

basics

menus

1 Press **[Main Menu]** to open the Main Menu.

2 Press the **navigation key** (up, down, right or left) to highlight a menu option.

3 Press the **centre key** (or **Select**) to select the highlighted option.

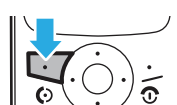
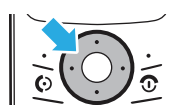
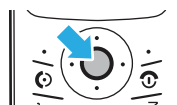

basics

emergency calls

To call the emergency number:

Press keypad keys to enter the emergency number, then press **[Call]** to call it.

Your service provider programmes one or more emergency phone numbers (such as 999) that you can call under any circumstances, even when your phone is locked or the SIM card is not inserted.

Note: Emergency numbers vary by country. Your phone's preprogrammed emergency number(s) may not work in all locations. Sometimes an emergency call cannot be placed due to network, environmental or interference issues.

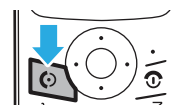

basics

voicemail

Find it: **[Messages]** > **[Voicemail]**

recent calls

Find it: **[Recent Calls]**

Shortcut: Press **[Recent Calls]** from the home screen to see a list of dialled calls.

lock/unlock your keypad

Press **[Lock]** > **[Unlock]** from the home screen to lock or unlock your keypad.

basics

status indicators

Status indicators show at the top of the home screen:

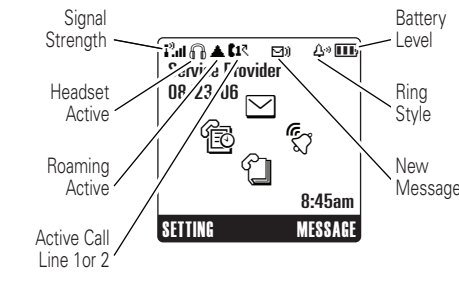

basics

menu map

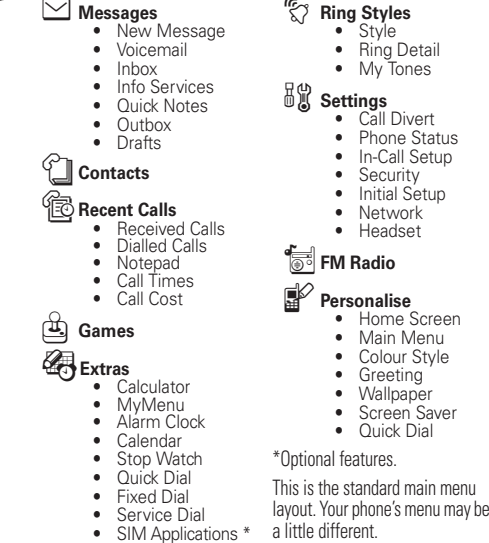

customise

change ring

To change ring volume:

Find it: **[Ring Styles]** > **[Style Detail]**

1 Scroll to **Ring Volume** and press **Change**.

2 Press **[Left/Right]** right or left to raise or lower volume.

To change ring style:

Find it: **[Ring Styles]** > **[Style]**

Scroll to the style you want and press **Select**.

⬅ Loud Ring

⬅ Vibrate

⬅ Vibe then Ring

⬅ Soft Ring

⬅ Vibe and Ring

⬅ Silent

customise

set phone to vibrate

Find it: **[Ring Styles]** > **[Style]**

Scroll to **Vibrate** and press **Select**.

TIP To quickly change to the vibrate mode, press and hold **[Vibrate]**. Press and hold **[Vibrate]** again to return to the previous ring style.

set wallpaper & screen saver

Find it: **[Personalise]** > **[Wallpaper]**

Find it: **[Personalise]** > **[Screen Saver]**

TIP This feature helps save your screen, but not your battery. To extend battery life, turn off the screen saver.

FM radio

listen to radio

1 Plug a 2.5 mm headset into your phone.

Note: The headset must be inserted into the phone for the FM radio to function. If you try to turn it on without inserting the earpiece, your phone will display **Please insert the earpiece**.

2 Press **[FM Radio]**.

3 Press **ON** (left soft key).

To tune to a station, press **[Left/Right]** left or right.

To scan available stations, hold **[Left/Right]** left or right.

To adjust volume, press **[Up/Down]** up or down.

To turn the radio off, press **FM Radio** or unplug the headset.

FM radio

store favourite stations

You can store up to nine FM stations as radio presets.

When listening to a station, **press and hold** a number key **[1]** to **[9]** to store the station as a preset.

To select a preset station, press the number key **[1]** to **[9]** for the station you want.

contacts

store contacts entry

1 Enter a phone number from the home screen.

2 Press **Store**.

3 Press **Change** to open the **Name** entry area.

4 Enter a name for the new contact entry.

5 Press **Done** to store the entry.

call contacts entry

Find it: **[Contacts]**

Scroll to the entry you want to call and press **[Call]**.

text messages

send a text message

Find it: Press **[Messages]** > **[Create]** > **[Create Message]** > **[SMS/EMS]**

1 Type the message and press **OK**. In text entry mode, press **[#]** to switch to iTap™ (predictive text entry), Tap Extended, Numeric or Symbol.

2 In the **Send** screen, enter the number you want to send to using the keypad keys and press **OK**.

3 Press **Send** when ready to send the message.

TIP Send messages in only 5 clicks! In the home screen, press the left arrow of the navigation key to enter directly into the text message editor. Type the text and press **Send To**. In the **Send** screen, select or enter the number you want to send your message to. Then click **Send**. It's that easy!

text messages

enter text

You can enter text for text messages:

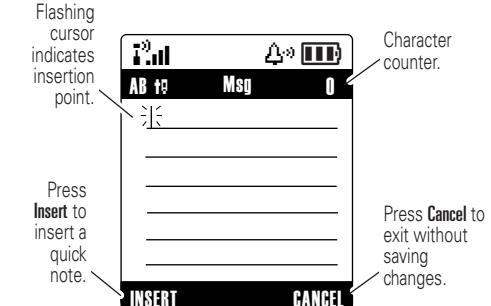

calendar

schedule an event

Find it: **[Extras]** > **[Calendar]**

> highlight a day > **[New]**

A title is required for a calendar event. All other information is optional.

view an event

Find it: **[Extras]** > **[Calendar]**

> highlight a day > **[Day View]** > highlight an entry > **[View]**

Battery Use & Battery Safety

- Motorola recommends you always use Motorola-branded batteries and chargers. The warranty does not cover damage caused by non-Motorola batteries and/or chargers. **Caution:** Use of an unqualified battery or charger may present a risk of fire, explosion, leakage or other hazard. Improper battery use or use of a damaged battery may result in a fire, explosion or other hazard.
- Battery usage by children should be supervised.
- Important:** Motorola mobile devices are designed to work best with qualified batteries. If you see a message on your display such as **Invalid Battery** or **Unable to Charge**, take the following steps:
 - Remove the battery and inspect it to confirm that it bears a Motorola "Original Equipment" hologram.
 - If there is no hologram, the battery is not a qualified battery.
 - If there is a hologram, replace the battery and retry charging it.
 - If the message remains, contact a Motorola Authorised Service Centre.
- New batteries or batteries stored for a long time may take more time to charge.
- Charging precautions:** When charging your battery, keep it near room temperature. Never expose batteries to temperatures below 0°C (32°F) or above 45°C (113°F) when charging. Always take your mobile device with you when you leave your vehicle.
- When storing your battery, keep it in a cool, dry place.
- It is normal over time for battery life to decrease and for the battery to exhibit shorter runtime between charges or require more frequent or longer charging times.
- Avoid damage to battery and mobile device.** Do not disassemble, open, crush, bend, deform, puncture, shred or submerge the battery or mobile device. Avoid dropping the battery or mobile device, especially on a hard surface. If your battery or mobile device has been subjected to such damage, take it to a Motorola Authorised Service Centre before using. Do not attempt to dry it with an appliance or heat source, such as a hair dryer or microwave oven.

- **Use care when handling a charged battery**—particularly when placing it inside a pocket, purse or other container with metal objects. Contact with metal objects (such as jewellery, keys, beaded chains) could complete an electrical circuit (short circuit), causing the battery to become very hot, which could cause damage or injury.

Promptly dispose of used batteries in accordance with local regulations. Contact your local recycling centre for proper battery disposal.

Warning: Never dispose of batteries in a fire because they may explode. Before using your phone, read the battery safety information in the "Safety and General Information" section.

Motorola, Inc., Consumer Advocacy Office,
1307 East Algonquin Road, Schaumburg, IL 60196



www.motorola.com

Certain mobile phone features are dependent on the capabilities and settings of your service provider's network. Additionally, certain features may not be activated by your service provider, and/or the provider's network settings may limit the feature's functionality. Always contact your service provider about feature availability and functionality. All features, functionality, and other product specifications, as well as the information contained in this user's guide are based upon the latest available information and are believed to be accurate at the time of printing. Motorola reserves the right to change or modify any information or specifications without notice or obligation.

Caution: Changes or modifications made in the radio phone, not expressly approved by Motorola, will void the user's authority to operate the equipment.

Software Copyright Notice

The Motorola products described in this manual may include copyrighted Motorola and third-party software stored in semiconductor memories or other media. Laws in the United States and other countries preserve for Motorola and third-party software providers certain exclusive rights for copyrighted software, such as the exclusive rights to distribute or reproduce the copyrighted software. Accordingly, any copyrighted software contained in the Motorola products may not be modified, reverse-engineered, distributed, or reproduced in any manner to the extent allowed by law. Furthermore, the purchase of the Motorola products shall not be deemed to grant either directly or by implication, estoppel, or otherwise, any license under the copyrights, patents, or patent applications of Motorola or any third-party software provider, except for the normal, non-exclusive, royalty-free license to use that arises by operation of law in the sale of a product.

Safety and General Information

This section contains important information on the safe and efficient operation of your mobile device. Read this information before using your mobile device.¹

Exposure to Radio Frequency (RF) Energy

Your mobile device contains a transmitter and receiver. When it is ON, it receives and transmits RF energy. When you communicate using your mobile device, the system handling your call controls the power level at which your mobile device transmits.

Your Motorola mobile device is designed to comply with local regulatory requirements in your country concerning exposure of human beings to RF energy.

Operational Precautions

For optimal mobile device performance and to be sure that human exposure to RF energy does not exceed the guidelines set forth in the relevant standards, always follow these instructions and precautions.

External Antenna Care

If your mobile device has an external antenna, use only a Motorola-supplied or approved replacement antenna. Use of antennas, modifications or attachments could damage the mobile device and/or may result in your device not complying with local regulatory requirements in your country. DO NOT hold the external antenna when the mobile device is IN USE. Holding the external antenna affects call quality and may cause the mobile device to operate at a higher power level than needed.

Product Operation

When placing or receiving a phone call, hold your mobile device just like you would a landline phone.

If you wear the mobile device on your body, always place the mobile device in a Motorola-supplied or approved clip, holder, holster, case or body harness. If you do not use a body-worn accessory supplied or approved by Motorola - or if you hang your mobile device from a lanyard around your neck - keep the mobile device and its antenna at least 2.5 centimetres (1 inch) from your body when transmitting.

When using any data feature of the mobile device, with or without an accessory cable, position the mobile device and its antenna at least 2.5 centimetres (1 inch) from your body.

Using accessories not supplied or approved by Motorola may cause your mobile device to exceed RF energy exposure guidelines. For a list of Motorola-supplied or approved accessories, visit our web site at: www.motorola.com.

RF Energy Interference/Compatibility

Nearly every electronic device is subject to RF energy interference from external sources if inadequately shielded, designed or otherwise configured for RF energy compatibility. In some circumstances your mobile device may cause interference with other devices.

Follow Instructions to Avoid Interference Problems

Turn off your mobile device in any location where posted notices instruct you to do so.

In an aircraft, turn off your mobile device whenever instructed to do so by airline staff. If your mobile device offers an airplane mode or similar feature, consult airline staff about using it in-flight.

Implantable Medical Devices

If you have an implantable medical device, such as a pacemaker or defibrillator, consult your doctor before using this mobile device.

Persons with implantable medical devices should observe the following precautions:

- ALWAYS keep the mobile device more than 20 centimetres (8 inches) from the implantable medical device when the mobile device is turned ON.
- DO NOT carry the mobile device in the breast pocket.

- Use the ear opposite the implantable medical device to minimise the potential for interference.

- Turn OFF the mobile device immediately if you have any reason to suspect that interference is taking place.

Read and follow the directions from the manufacturer of your implantable medical device. If you have any questions about using your mobile device with your implantable medical device, consult your health care provider.

Driving Precautions

Check the laws and regulations on the use of mobile devices in the area where you drive. Always obey them.

When using your mobile device while driving, please:

- Give full attention to driving and to the road. Using a mobile device may be distracting. Discontinue use if you cannot concentrate on driving.
- Use hands-free operation, if available.
- Pull off the road and park before making or answering a call if driving conditions so require.
- Do not place a mobile device in the airbag deployment area.

Responsible driving practices can be found in the "Smart Practices While Driving" section at the end of this guide and/or at the Motorola web site: www.motorola.com/callsmart.

Note: The use of wireless phones while driving may cause distraction. Discontinue a call if you can't concentrate on driving. Additionally, the use of wireless devices and their accessories may be prohibited or restricted in certain areas. Always obey the laws and regulations on the use of these products.

Operational Warnings

Obey all posted signs when using mobile devices in public areas.

Potentially Explosive Atmospheres

Areas with potentially explosive atmospheres are often but not always posted and can include fuelling areas such as below decks on boats, fuel or chemical transfer or storage facilities or areas where the air contains chemicals or particles, such as grain, dust or metal powders.

When you are in such an area, turn off your mobile device and do not remove, install or charge batteries. In such areas, sparks can occur and cause an explosion or fire.

Symbol Key

Your battery, charger or mobile device may contain symbols, defined as follows:

Symbol	Definition
	Important safety information follows.
	Do not dispose of your battery or mobile device in a fire.
	Your battery or mobile device may require recycling in accordance with local laws. Contact your local regulatory authorities for more information.
	Do not throw your battery or mobile device in a rubbish bin.
	Your mobile device contains an internal lithium ion battery.
	Do not let your battery, charger or mobile device get wet.
	Listening at full volume to music or voice through a headset may damage your hearing.

Batteries and Chargers

Caution: Improper treatment or use of batteries may present a danger of fire, explosion, leakage or other hazard. For more information, see the "Battery Use & Battery Safety" section in this user's guide.

Choking Hazards

Your mobile device or its accessories may include detachable parts, which may present a choking hazard to small children. Keep your mobile device and its accessories away from small children.

Glass Parts

Some parts of your mobile device may be made of glass. This glass could break if the product is dropped on a hard surface or receives a substantial impact. If glass breaks, do not touch or attempt to remove. Stop using your mobile device until the glass is replaced by a qualified service centre.

Seizures/Blackouts

Some people may be susceptible to epileptic seizures or blackouts when exposed to flashing lights, such as when playing video games. These may occur even if a person has never had a previous seizure or blackout. If you have experienced seizures or blackouts or if you have a family history of such occurrences, please consult with your doctor before playing video games or enabling a flashing-lights feature (if available) on your mobile device. Discontinue use and consult a doctor if any of the following symptoms occur: convulsion, eye or muscle twitching, loss of awareness, involuntary movements or disorientation. It is always a good idea to hold the screen away from your eyes, leave the lights on in the room, take a 15-minute break every hour and stop use if you are very tired.

Caution About High Volume Usage

Listening at full volume to music or voice through a headset may damage your hearing.



Repetitive Motion

When you repetitively perform actions such as pressing keys or entering finger-written characters, you may experience occasional discomfort in your hands, arms, shoulders, neck or other parts of your body. If you continue to have discomfort during or after such use, stop use and see a doctor.

FCC Notice to Users

The following statement applies to all products that have received FCC approval. Applicable products bear the FCC logo, and/or an FCC ID in the format FCC ID-XXXXX on the product label.

Motorola has not approved any changes or modifications to this device by the user. Any changes or modifications could void the user's authority to operate the equipment. See 47 CFR Sec. 15.21.

This device complies with part 15 of the FCC Rules. Operation is subject to the following two conditions: (1) This device may not cause harmful interference, and (2) this device must accept any interference received, including interference that may cause undesired operation. See 47 CFR Sec. 15.19(c).

This equipment has been tested and found to comply with the limits for a Class B digital device, pursuant to part 15 of the FCC Rules. These limits are designed to provide reasonable protection against harmful interference in a residential installation. This equipment generates, uses and can radiate radio frequency energy and, if not installed and used in accordance with the instructions, may cause harmful interference to radio communications. However, there is no guarantee that interference will not occur in a particular installation. If this equipment does cause harmful interference to radio or television reception, which can be determined by turning the equipment off and on, the user is encouraged to try to correct the interference by one or more of the following measures:

- Reorient or relocate the receiving antenna.
- Increase the separation between the equipment and the receiver.
- Connect the equipment to an outlet on a circuit different from that to which the receiver is connected.
- Consult the dealer or an experienced radio/TV technician for help.

Information from the World Health Organisation

Present scientific information does not indicate the need for any special precautions for the use of mobile phones. If you are concerned, you may want to limit your own or your children's RF exposure by limiting the length of calls or by using handsfree devices to keep mobile phones away from your head and body.

Source: WHO Fact Sheet 193

Further information:

http://www.who.int./peh-emf

Caring for the Environment by Recycling

This symbol on a Motorola product means the product should not be disposed of with household waste.

Disposal of your Mobile Device and Accessories

Please do not dispose of mobile devices or electrical accessories (such as chargers, headsets or batteries) with your household waste. These items should be disposed of in accordance with the national collection and recycling schemes operated by your local or regional authority. Alternatively, you may return unwanted mobile devices and electrical accessories to any Motorola Approved Service Centre in your region. Details of Motorola approved national recycling schemes and further information on Motorola recycling activities can be found at: www.motorola.com/recycling.

Disposal of your Mobile Device Packaging and User's Guide

Product packaging and user's guides should only be disposed of in accordance with national collection and recycling requirements. Please contact your regional authorities for more details.

Privacy and Data Security

Motorola understands that privacy and data security are important to everyone. Given that some features of your mobile device may affect your privacy or data security, please follow these recommendations to enhance protection of your information:

- **Monitor access**—Keep your mobile device with you and do not leave it where others may have unmonitored access. Lock your device's keypad where this feature is available.
- **Keep software up to date**—If Motorola or a software/application vendor releases a patch or software fix for your mobile device which updates the device's security, install it as soon as possible.
- **Erase before recycling**—Delete personal information or data from your mobile device prior to disposing of it or turning it in for recycling. For step-by-step instructions on how to delete all personal information from your device, see the section entitled "master clear" or "delete data" in this user's guide.

Note: For information on backing up your mobile device data before erasing it, go to www.motorola.com and then navigate to the "downloads" section of the consumer web page for "Motorola Backup" or "Motorola Phone Tools."

- **Understanding AGPS**—In order to comply with the emergency caller location requirements of Ofcom, certain Motorola mobile devices incorporate Assisted Global Positioning System (AGPS) technology. AGPS technology also can be used in non-emergency applications to track and monitor a user's location, for example, to provide driving directions. Users who prefer not to permit such tracking and monitoring should avoid using such applications.

If you have further questions regarding how use of your mobile device may impact your privacy or data security, please contact Motorola at: privacy@motorola.com, or contact your service provider.

Smart practices while driving

Drive Safe, Call Smart SM

Check the laws and regulations on the use of mobile devices and their accessories in the areas where you drive. Always obey them. The use of these devices may be prohibited or restricted in certain areas. Go to www.motorola.com/callsmart for more information.

Your mobile device lets you communicate by voice and data, almost anywhere, anytime, wherever wireless service is available and safe conditions allow. When driving a car, driving is your first responsibility. If you choose to use your mobile device while driving, remember the following tips:

- **Get to know your Motorola mobile device and its features such as speed dial and redial.** If available, these features help you to place your call without taking your attention off the road.

- **When available, use a hands-free device.** If possible, add an additional layer of convenience to your mobile device with one of the many Motorola Original hands-free accessories available today.



- **Position your mobile device within easy reach.** Be able to access your mobile device without removing your eyes from the road. If you receive an incoming call at an inconvenient time, if possible, let your voice mail answer it for you.

- **Let the person you are speaking with know you are driving; if necessary, suspend the call in heavy traffic or hazardous weather conditions.** Rain, sleet, snow, ice, and even heavy traffic can be hazardous.

- **Do not take notes or look up phone numbers while driving.** Jotting down a "to do" list or going through your address book takes attention away from your primary responsibility—driving safely.

¹ Wherever wireless phone service is available.

European Union Directives Conformance Statement

Hereby, Motorola declares that this product is in compliance with:

- The essential requirements and other relevant provisions of Directive 1999/5/EC
- All other relevant EU Directives

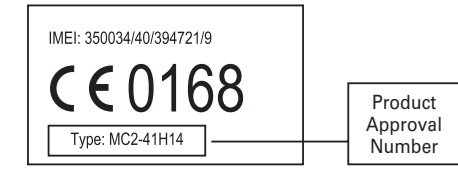

The above gives an example of a typical Product Approval Number. You can view your product's Declaration of Conformity (DoC) to Directive 1999/5/EC (to R&TTE Directive) at www.motorola.com/rte. To find your DoC, enter the product Approval Number from your product's label in the "Search" bar on the Web site.

Specific Absorption Rate Data

This model meets international guidelines for exposure to radio waves.

Your mobile device is a radio transmitter and receiver. It is designed not to exceed the limits for exposure to radio waves recommended by international guidelines. These guidelines were developed by the independent scientific organization ICNIRP and include safety margins designed to assure the protection of all persons, regardless of age and health.

The guidelines use a unit of measurement known as the Specific Absorption Rate, or SAR. The ICNIRP SAR limit for mobile devices used by the general public is 2 W/kg and the highest SAR value for this device when tested at the ear was 0.51 W/kg.¹ As mobile devices offer a range of functions, they can be used in other positions, such as on the body as described in this user guide.² In this case, the highest tested SAR value is 0.77 W/kg.¹

As SAR is measured utilising the device's highest transmitting power, the actual SAR of this device while operating is typically below that indicated above. This is due to automatic changes to the power level of the device to ensure it only uses the minimum level required to reach the network. While there may be differences between the SAR levels of various phones and at various positions, they all meet the governmental requirements for safe exposure. Please note that improvements to this product model could cause differences in the SAR value for later products; in all cases, products are designed to be within the guidelines.

¹ The tests are carried out in accordance with international guidelines for testing. The limit incorporates a substantial margin for safety to give additional protection for the public and to account for any variations in measurements. Additional related information includes the Motorola testing protocol, assessment procedure, and measurement uncertainty range for this product.

² Please see the Safety and General Information section about body worn operation.

The World Health Organization has stated that present scientific information does not indicate the need for any special precautions for the use of mobile devices. They note that if you want to reduce your exposure then you can do so by limiting the length of calls or using a "hands-free" device to keep the mobile phone away from the head and body.

Additional Information can be found on the websites of the World Health Organization (<http://www.who.int/emf>) or Motorola, Inc. (<http://www.motorola.com/rfhealth>).

WARRANTY INFORMATION

Motorola guarantees to you, the original purchaser, the Personal Communicator and accessories which you have purchased from an authorised Motorola dealer (the "Products"), to be in conformance with the applicable Motorola specifications current at the time of manufacture for a term of 1 year from date of purchase of the Product(s) (Warranty Term).

You must inform Motorola of the lack of conformity to the applicable specifications of any of the Products within a period of two (2) months from the date on which you detect a defect in material, workmanship or lack of conformity and in any event within a term not to exceed the Warranty Term, and must immediately submit the Product for service to Motorola's Authorised Repair or Service Centre. Motorola shall not be bound by Product related statements not directly made by Motorola nor any warranty obligations applicable to the seller.

A list of the Motorola Call Centre numbers is enclosed with this Product. During the Warranty term, Motorola will, at its discretion and without extra charge, as your exclusive remedy, repair or replace your Product which does not comply with this warranty; or failing this, to reimburse the price of the Product but reduced to take into account the use you have had of the Product since it was delivered. This warranty will expire at the end of the Warranty Term. This is the complete and exclusive warranty for a Motorola Personal Communicator and accessories and in lieu of all other warranties, terms and conditions, whether express or implied.

¹ including without limitation loss of use, loss of time, loss of data, inconvenience, commercial loss, lost profits or savings.