

User guide

C903

Thank you for purchasing a Sony Ericsson C903 Cyber-shot™. For additional phone content, go to www.sonyericsson.com/tun. Register now to get free online storage and special offers at www.sonyericsson.com/myphone. For product support, go to www.sonyericsson.com/support. Please read the *Important information* before you use your mobile phone.

Instruction symbols

These symbols may appear in the User guide.

- ! Note
- 💡 Tip
- ⚠ Warning
- > Use a selection or navigation key to scroll and select. See *Navigation* on page 12.

Getting started

Assembly

Before you start using your phone, you need to insert a SIM card and the battery.

To insert the SIM card



- 1 Unlock the battery cover lock.
- 2 Remove the battery cover.
- 3 Slide the SIM card into its holder with the gold-coloured contacts facing down.

To insert the battery



- 1 Insert the battery with the label side up and the connectors facing each other.
- 2 Attach the battery cover and lock it.

Turning on the phone

To turn on the phone



- 1 Press and hold down ①.
- 2 Enter your SIM card PIN, if requested, and select **OK**.
- 3 Select a language.
- 4 Follow the instructions to use the setup wizard for basic settings and useful tips.

💡 If you want to correct a mistake when you enter your PIN, press (C).

Help

In addition to this User guide, an extended User guide, Feature guides and more information are available at www.sonyericsson.com/support. Help and information are also available in your phone.

To access the User guide

- Select **Menu** > **Settings** > **User help** > **User guide**.

To view tips and tricks

- Select **Menu** > **Settings** > **User help** > **Tips and tricks**.

To view information about functions

- Scroll to a function and select **Info**, if available. In some cases, **Info** appears under **Options**.

Charging the battery

The phone battery is partly charged when you buy it.

To charge the battery



- 1 Connect the charger to the phone. It takes approximately 2.5 hours to fully charge the battery. Press a key to view the screen.
- 2 Remove the charger by tilting the plug upwards.

💡 You can use your phone while it is charging. You can charge the battery at any time and for more or less

Phone overview

- 1 Ear speaker
- 2 Screen light sensor
- 3 Screen
- 4 Connector for charger, handsfree and USB cable
- 5 Selection keys
- 6 Navigation key
- 7 Call key
- 8 Activity menu key
- 9 Memory card slot (under the cover)
- 10 Loudspeaker
- 11 Video call camera*
- 12 End, On/off key
- 13 C key (Clear)



- 14 Camera lens
- 15 Volume, digital zoom keys
- 16 Flash
- 17 Camera view/mode key
- 18 Camera key

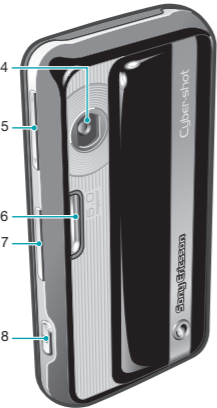

*Video call camera may not be available in every market.

Menu overview*

PlayNow™

Cyber-shot™

Location services

Calls**

All

Answered

Dialled

Missed

Internet

Messaging

Write new, Inbox / Conversations, Messages, Email, IM, Call voicemail

Contacts

Myself, New contact

Organiser

File manager **, Alarms, Applications, Video call, Calendar, Tasks, Notes, Synchronisation, Timer, Stopwatch, Calculator, Code memo

Entertainment

Online services, TrackID™, Games, VideoDJ™, PhotoDJ™, MusicDJ™, Remote control, Record sound, Demo tour

Media

Photo, Music, Video, Games, Web feeds, Settings

Radio

Settings

General

Profiles, Time & date, Language, Update service, Voice control, New events, Shortcuts, Flight mode, Security,

Setup wizard, Accessibility, Phone status, Master reset

Sounds & alerts

Ring volume, Ringtones, Silent mode, Increasing ring, Vibrating alert, Message alert, Key sound

Display

Wallpaper, Main menu layout, Theme, Startup screen, Screen saver, Clock size, Brightness, Edit line names

Calls

Speed dial, Smart search, Divert calls, Switch to line 2, Manage calls, Time & cost, Show/hide my no., Handsfree, Open to answer, Close to end call

Connectivity

Bluetooth, USB, Phone name, Synchronisation,

Device management, Mobile networks, Data communication, Internet settings, Streaming settings, Message settings, SIP settings, Accessories

User help

User guide, Settings download, Basic setup, Tips and tricks

* Some menus are operator-, network- and subscription-dependent.

** You can use the navigation key to scroll between tabs in submenus. For more information, see *Navigation* on page 12.

Navigation

To access the main menu

- When **Menu** appears on the screen, press the centre selection key to select **Menu**.
- If **Menu** does not appear on the screen, press (↵), and then press the centre selection key to select **Menu**.

To navigate the phone menus

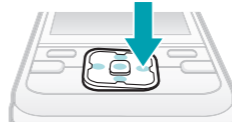

- Press the navigation key (↵), (⬅), (➡) or (⬇) to move through the menus.

To end a function

- Press (C).

To return to standby

- Press (C).

To delete items

- Press (C) to delete items such as numbers, letters, pictures and sounds.

Memory card

⚠ You may have to purchase a memory card separately.

Your phone supports Memory Stick Micro™ (M2™) memory card adding more storage space to your phone. It

can also be used as a portable memory card with other compatible devices.

You can move content between a memory card and the phone memory. See *Handling content in the phone* on page 25.

To insert a memory card



- Remove the battery cover and insert the memory card with the gold-coloured contacts facing up.

To remove a memory card

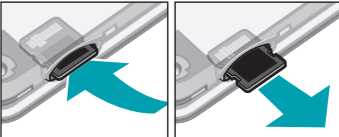

- Remove the battery cover and press the edge of the memory card to release and remove it.

Entering text

You can use multitap text input or T9™ Text Input to enter text. The T9 Text Input method uses a built-in dictionary.

To change text input method

- When you enter text, press and hold down (⌘).

To shift between capitals and lower-case letters

- When you enter text, press (⌘).

To enter numbers

- When you enter text, press and hold down (0) - (9).

To enter full stops and commas

- When you enter text, press (1).

To enter a symbol

- 1 When you enter text, select **Options** > **Add symbol**.
- 2 Scroll to a symbol and select **Insert**.

To enter text using T9™ Text Input

- 1 Select, for example, **Menu** > **Messaging** > **Write new** > **Message**.
- 2 If T9 is not displayed, press and hold down (⌘) to change to T9 Text Input.
- 3 Press each key only once, even if the letter you want is not the first letter on the key. For example, to write the word "Jane", press (5), (2), (6), (3). Write the whole word before looking at the suggestions.
- 4 Use (↵) or (⬅) to view suggestions.
- 5 Press (↵) to accept a suggestion.

To enter text using multitap

- 1 From standby select, for example, **Menu** > **Messaging** > **Write new** > **Message**.
- 2 If T9 is displayed, press and hold down (⌘) to change to multitap text input.
- 3 Press (2) - (9) repeatedly until the desired letter appears.
- 4 When a word is written, press (↵) to add a space.

Calling

Making and receiving calls

You need to turn on your phone and be within range of a network.

To make a call

- 1 Enter a phone number (with international country code and area code, if applicable).

- 2 Press (C).

💡 You can call numbers from your contacts and call list. See *Contacts* on page 17, and *Call list* on page 17.

To end a call

- Press (C).

To make international calls

- 1 Press and hold down (0) until a "+" sign appears.
- 2 Enter the country code, area code (without the first zero) and phone number.
- 3 Press (C).

To answer a call

- Press (C).

To reject a call

- Press (C).

To change the ear speaker volume during a call

- 1 Press and hold down (C).
- 2 Press and hold down (C) again to resume.

To mute the microphone during a call

- 1 Press and hold down (C).
- 2 Press and hold down (C) again to resume.

To turn on the loudspeaker during a call

- Press **SpkOn**.

⚠ Do not hold your phone to your ear when using the loudspeaker. This could damage your hearing.

Emergency calls

Your phone supports international emergency numbers, for example, 112 or 911. You can normally use these numbers

to make emergency calls in any country, with or without the SIM card inserted, if you are within range of a network.

⚠ In some countries, other emergency numbers may also be promoted. Your network operator may therefore have saved additional local emergency numbers on the SIM card.

To make an emergency call

- Enter 112 (the international emergency number) and press (C).

To view your local emergency numbers

- 1 Select **Menu** > **Contacts**.
- 2 Scroll to **New contact** and select **Options** > **Special numbers** > **Emergency nos.**

Call list

You can view information about recent calls.

To call a number from the call list

- 1 Press (C) and scroll to a tab.
- 2 Scroll to a name or a number and press (C).

Contacts

You can save names, phone numbers and personal information in **Contacts**. Information can be saved in the phone memory or on the SIM card.

💡 You can synchronise your contacts using the *Sony Ericsson PC Suite*.

To add a phone contact

- 1 Select **Menu** > **Contacts**.
- 2 Scroll to **New contact** and select **Add**.
- 3 Enter the name and select **OK**.

- 4 Scroll to **New number**: and select **Add**.
- 5 Enter the number and select **OK**.
- 6 Select a number option.
- 7 Scroll between the tabs and add information to the fields.
- 8 Select **Save**.

Calling contacts

To call with Smart search

- 1 Press (0) - (9) to enter a sequence of (at least two) digits. All entries which match the sequence of digits or corresponding letters are shown in a list.
- 2 Scroll to a contact or a phone number and press (C).

To turn on or off Smart search

- 1 Select **Menu** > **Settings** > **Calls** > **Smart search**.
- 2 Select an option.

Cyber-shot™

You can take photos and record video clips to view, save or send. You find saved photos and video clips in **Media** and in **File manager**.

Using the camera

To activate the camera

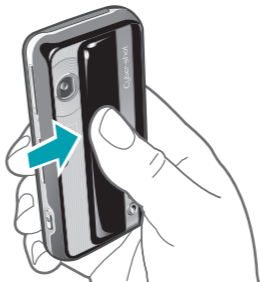

- Open the retractable lens cover.

Viewfinder and camera keys

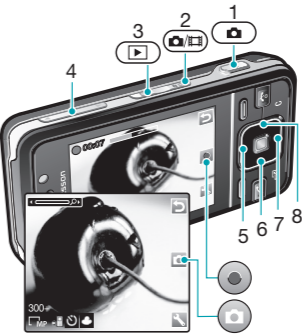

- 1 Take a photo/Record a video clip
- 2 Select still camera or video camera
- 3 View photos and video clips
- 4 Zoom in or out
- 5 Photo: **Focus**
- 6 **Self-timer**
- 7 Photo: **Flash Video: Light**
- 8 Brightness

To take a photo

- 1 Activate the camera and press (C) to select (C).
- 2 Press (C) halfway down to use auto focus.
- 3 When the dot and focus frame are green, press (C) fully down to take a photo. The photo is automatically saved.

To record a video clip

- 1 Activate the camera and press (C) to select (C).
- 2 Press (C) fully down to start recording.
- 3 To stop recording, press (C) fully down. The video clip is automatically saved.

To use zoom

- Press the volume key.

To view photos and video clips

- 1 Activate the camera and press (C).
- 2 Scroll to the item.
- 3 To view a video clip, press the centre selection key.

More camera features

To change settings

- Activate the camera and select (C).

To view information about settings

- Scroll to a setting and select (C).

Photo fix

You can use Photo fix to improve photos. In a one-click operation, brightness, light and contrast are adjusted to give you the best possible photo. The improvements are saved as a copy of the photo. The original photo is not affected.

To improve a photo with Photo fix

- 1 Activate the camera and press (C) to select (C).

- 2 Make sure **Review** is set to **On**. Select > **Settings** and scroll to **Review** > **On**. Select to return to the viewfinder.
- 3 Take a photo.
- 4 During review, select **Options** > **Photo fix**.

Face detection

You can use face detection to bring an off-centre face into focus. The camera automatically detects up to three faces, indicated by white frames. A green frame shows which face has been selected when auto-focus is used. Focus is set to the face closest to the camera.

To set face detection

- 1 Activate the camera and press to select .
- 2 Select > **Focus** > **Face detection**.

Smile Shutter™

Smile Shutter allows you to capture the smiles of family and friends. The camera detects up to three faces and selects one face for smile detection and auto focus. A yellow frame shows which face is selected. When the selected face smiles, the camera automatically takes a photo.

To set Smile Shutter™

- 1 Activate the camera and press to select .
- 2 Select > **Shoot mode** > **Smile Shutter™**.
- 3 When appears, the camera is in Smile Shutter mode.

To use Smile Shutter™

- 1 Activate the camera and press to select .
- 2 When you see the yellow frame, press fully down. When appears, smile detection is activated.
- 3 The camera automatically takes the photo when the subject smiles.

- 4 To take a photo although no smile is detected, press fully down again.

Music

You can listen to music, audio books and podcasts. Use Media Go™ to transfer content to and from your phone. For more information, see *Transferring content to and from a computer* on page 27.

Stereo portable handsfree



Music player

To play music

- 1 Select **Menu** > **Media** > **Music**.
- 2 Browse by category using the navigation key.

- 3 Scroll to a title and select **Play**.

To stop playing music

- Press the centre selection key.

To fast forward and rewind

- Press and hold down or .

To move between tracks

- Press or .

To change the volume

- Press the volume key up or down.

TrackID™

TrackID™ is a music recognition service. You can search for title, artist and album name for a track you hear playing through a loudspeaker or on the radio in your phone. If you cannot use TrackID™, see *I cannot use Internet-based services* on page 35.

To search for track information

- When you hear a track through a loudspeaker, select **Menu** > **Entertainment** > **TrackID™** > **Start**.
- When the radio in your phone is playing select **Options** > **TrackID™**.

- For best results, use TrackID™ in a quiet area.

Radio

- Do not use your phone as a radio in places where this is prohibited.

To turn on the radio

- 1 Connect a handsfree to the phone.
- 2 Select **Menu** > **Radio**.

Saving channels

You can save up to 20 preset channels.

To save channels automatically

- Select **Options** > **Auto save**.

To switch between saved channels

- Press or .

Transferring and handling content

You can transfer and handle content such as pictures and music.

- You are not allowed to exchange some copyright-protected material. identifies a protected item.

Handling content in the phone

You can use **File manager** to handle content saved in the phone memory or on a memory card. Tabs and icons in **File manager** show where the content is saved. If the memory is full, delete some content to create space.

To select more than one item in a folder

- 1 Select **Menu** > **Organiser** > **File manager**.
- 2 Scroll to a folder and select **Open**.
- 3 Select **Options** > **Mark** > **Mark several**.

- 4 For each item you want to mark, scroll to the item and select **Mark**.

To move items between the phone memory and the memory card

- 1 Select **Menu** > **Organiser** > **File manager**.

More features

Flight mode

In **Flight mode** the network and radio transceivers are turned off to prevent disturbance to sensitive equipment. When the flight mode menu is activated you are asked to select a mode the next time you turn on your phone:

- **Normal mode** – full functionality
- **Flight mode** – limited functionality

To activate the flight mode menu

- Select **Menu** > **Settings** > **General** > **Flight mode** > **Continue** > **Show at startup**.

To select flight mode

- 1 When the flight mode menu is activated, turn off your phone.
- 2 Turn on your phone and select **Flight mode**.

Update Service

You can update your phone with the latest software using your phone or a PC.

- Updating using your phone is not possible in all countries/regions.

To view the current software in the phone

- 1 Select **Menu** > **Settings** > **General** > **Update service**.
- 2 Select **Software version**.

- 2 Find an item and select **Options** > **Manage file** >

Move.

- 3 Select **Memory card** or **Phone**.

- 4 Scroll to a folder and select **Open**.

- 5 Select **Paste**.

Sending content to another phone

You can send content, for example, in messages or using Bluetooth™ wireless technology.

To send content

- 1 Scroll to an item and select **Options** > **Send**.
- 2 Select a transfer method.

- Make sure the receiving device supports the transfer method you select.

Using a USB cable

You can connect your phone to a computer with a USB cable to synchronise, transfer and back up phone content and use your phone as a modem. For more information, go to www.sonyericsson.com/support to read Feature guides.

- You may have to purchase a USB cable separately.

Before using a USB cable

See *Required operating systems* on page 27.

- Only use a USB cable supported by your phone. Do not remove the USB cable from your phone or computer during transfer as this may corrupt the memory card or the phone memory.

To disconnect the USB cable safely

- 1 **Computer:** Close any software that you are using with your phone.
- 2 Disconnect the USB cable.

Drag and drop content

You can drag and drop content between your phone, a memory card and a computer in *Microsoft Windows Explorer*.

To drag and drop content

- 1 Connect your phone to a computer using a USB cable.
- 2 **Phone:** Select **Media transfer**. The phone will remain activated during file transfer.
- 3 **Computer:** Wait until the phone memory and memory card appear as external disks in *Windows Explorer*.
- 4 Drag and drop selected files between the phone and the computer.

Transferring content to and from a computer

You can use Media Go™ to transfer media content between your phone and a computer.

- Media Go™ is available for download at www.sonyericsson.com/support.

Required operating systems

You need one of these operating systems to use Sony Ericsson PC software:

- Microsoft® Windows Vista™
- Microsoft® Windows XP, Service Pack 2 or higher

To download Media Go™

- 1 **Computer:** In your Internet browser, go to www.sonyericsson.com/support.
- 2 Select a region and country.
- 3 Select **Software downloads**.
- 4 Select a phone from the list.
- 5 Select **Read more and download** under Media Go™.
- 6 Select **Download now** and save the file to your computer.

- Remember where you save the file.

To install Media Go™ from the downloaded file

- 1 Locate the downloaded Media Go™ file on the computer.
- 2 Double-click the file and follow the instructions.

To transfer content using Media Go™

- Do not remove the USB cable from your phone or computer during transfer, as this may corrupt the memory card or the phone memory.

- 1 Connect the phone to a computer with a USB cable supported by your phone.
- 2 **Computer:** Select *Start/Programs/Sony/Media Go™*.
- 3 **Phone:** Select **Media transfer**.
- 4 **Computer:** Select *Transfer to or from Device using Media Go™* and click **OK**.
- 5 Wait until the phone appears in Media Go™.
- 6 Move files between your phone and the computer in Media Go™.

Backing up and restoring

You can backup and restore contacts, the calendar, tasks, notes and bookmarks using the *Sony Ericsson PC Suite*.

Before backing up and restoring, you need to install the *Sony Ericsson PC Suite*, which is available from www.sonyericsson.com/support.

You can backup and restore contacts within your phone using a Memory Stick Micro™ (M2™) memory card. You can move content between the memory card and the phone memory. See *Handling content in the phone* on page 25.

- Back up your phone content regularly to make sure you do not lose it.

To make a backup using the Sony Ericsson PC Suite

- 1 **Computer:** Start the *Sony Ericsson PC Suite* from *Start/Programs/Sony Ericsson/Sony Ericsson PC Suite*.
- 2 Follow the instructions in the *Sony Ericsson PC Suite* for how to connect.
- 3 **Phone:** Select **Phone mode**.
- 4 **Computer:** Go to the backup and restore section in the *Sony Ericsson PC Suite* and make a backup.

Messaging

To view a message from the inbox

- 1 Select **Menu** > **Messaging** > **Inbox**.
- 2 Scroll to the message and select **View**.

Sending messages

You can send messages from your phone. The maximum size of a standard text message is 160 characters including spaces if no other items are added to the message. If you enter more than 160 characters, a second message is created. Your messages are sent as one concatenated message.

To create and send a message

- 1 Select **Menu** > **Messaging** > **Write new** > **Message**.
- 2 Enter text. To add items to the message, press , scroll and select an item.
- 3 Select **Continue** > **Contacts look-up**.
- 4 Select a recipient and select **Send**.

- If you send a message to a group, you will be charged for each member.

Internet

If you cannot use the Internet, see *I cannot use Internet-based services* on page 35.

To start browsing

- 1 Select **Search**.
- 2 Enter a Web address, a search phrase or the name of a bookmark.
- 3 Scroll to an item in the list and select **Go to** or **Search**.

To exit the browser

- Select **Options** > **Exit browser**.

GPS

Your phone has a GPS receiver that uses satellite signals to calculate your location.

- If you cannot use some GPS features, see *I cannot use Internet-based services* on page 35.

Using GPS

Your location can be found when you have a clear view of the sky. If your location is not found after a few minutes, move to another location. To help the search, stand still and do not cover the GPS antenna.

- The first time you use the GPS it may take up to 10 minutes before your location is found.



Assisted start

With **Assisted start** your location is calculated more quickly. If not turned off, **Assisted start** will automatically be used to find your location when Assisted GPS (A-GPS) technology is available.

To set when to use Assisted start

- 1 Select **Menu** > **Location services** > **Settings** > **Assisted start**.
- 2 Select an option.

Publication number: 1224-4022.1

Attention: Some of the services and features described in this User guide are not supported by all networks and/or service providers in all areas. Without limitation, this applies to the GSM International Emergency Number 112. Please contact your network operator or service provider to determine availability of any specific service or feature and whether additional access or usage fees apply.

Your mobile phone has the capability to download, store and forward additional content, e.g. ringtones. The use of such content may be restricted or prohibited by rights of third parties, including but not limited to restriction under applicable copyright laws. You, and not Sony Ericsson, are entirely responsible for additional content that you download to or forward from your mobile phone. Prior to your use of any additional content, please verify that your intended use is properly licensed or is otherwise authorized. Sony Ericsson does not guarantee the accuracy, integrity or quality of any additional content or any other third party content. Under no circumstances will Sony Ericsson be liable in any way for your improper use of additional content or other third party content.

Bluetooth is a trademark or a registered trademark of Bluetooth SIG Inc. and any use of such mark by Sony Ericsson is under license.

The Liquid Identity logo, BestPic, PlayNow, MusicDJ, PhotoDJ, TrackID, Style-Up and VideoDJ are trademarks or registered trademarks of Sony Ericsson Mobile Communications AB.

TrackID™ is powered by Gracenote Mobile MusicID™. Gracenote and Gracenote Mobile MusicID are trademarks or registered trademarks of Gracenote, Inc.

Cyber-shot, Smile Shutter, Sony, Memory Stick Micro™, M2™ and Media Go are trademarks or registered trademarks of Sony Corporation. Google™, Google Maps™, YouTube and the YouTube logo are trademarks or registered trademarks of Google, Inc.

Wayfinder and Wayfinder Navigator are trademarks or registered trademarks of Wayfinder Systems AB.

Ericsson is a trademark or registered trademark of Telefonaktiebolaget LM Ericsson.

Microsoft, Windows and Vista are registered trademarks or trademarks of Microsoft Corporation in the United States and/or other countries.

T9™ Text Input is a trademark or a registered trademark of Tegic Communications. T9™ Text Input is licensed under one or more of the following: U.S. Pat. Nos. 5,818,437, 5,953,541, 5,187,480, 5,945,928,

and 6,011,554; Canadian Pat. No. 1,331,057, United Kingdom Pat. No. 2238414B; Hong Kong Standard Pat. No. HK0940329; Republic of Singapore Pat. No. 51383; Euro.Pat. No. 0 842 463(96927260.8) DE/DK, FI, FR, IT, NL, PT, ES, SE, GB; and additional patents are pending worldwide.

This product is protected by certain intellectual property rights of Microsoft. Use or distribution of such technology outside of this product is prohibited without a license from Microsoft.

Other product and company names mentioned herein may be the trademarks of their respective owners.

Any rights not expressly granted herein are reserved.

All illustrations are for illustration only and may not accurately depict the actual phone.

I have problems with memory capacity or the phone is working slowly

Restart your phone every day to free memory or do a **Master reset**.

www.sonyericsson.com



Sony Ericsson

Sony Ericsson Mobile Communications AB
SE-221 88 Lund, Sweden

1224-4022.1